



| | | | Page |
|---|-------------------------------------|---|--------------|
| ACO channel | Introduction | Hygienic design | 82 |
| | | System overview | 83 |
| | ACO box channel | Introduction | 84 |
| | | ACO hygienic box channel - standard articles | 86 |
| | | ACO hygienic box channel - semi-standard | 89 |
| | | ACO vinyl box channel - standard articles | 90 |
| | | ACO vinyl box channel - semi-standard | 92 |
| | | ACO hygienic cast grating | 93 |
| | | ACO hygienic ladder grating | 94 |
| | | ACO mesh grating | 98 |
| | | Accessories for ACO hygienic box channel | 100 |
| | | ACO customized box channel | 102 |
| | | ACO slot channel | Introduction |
| | ACO slot channel - semi-standard | | 108 |
| | ACO customized slot channel | | 109 |
| | ACO modular channel | Introduction | 114 |
| | | ACO modular box channel 125 - standard articles | 118 |
| | | Gratings for ACO modular box channel 125 | 124 |
| | | Accessories for ACO modular box channel 125 | 128 |
| | | ACO modular box channel 200 - standard articles | 129 |
| | | Gratings for ACO modular box channel 200 | 137 |
| | | Accessories for ACO modular box channel 200 | 140 |
| ACO modular slot channel 20 - standard articles | | 141 | |
| Accessories for ACO modular slot channel 20 | | 146 | |
| ACO modular channel - semi-standard | 147 | | |
| ACO design channel | ACO design channel | 148 | |
| Flow rates | Flow rates and Construction heights | 149 | |

Hygienic design

ACO offers sustainable, integrated drainage systems which are designed to protect your business, the environment and ultimately public health. Our aim is to constantly improve every aspect of safety, hygiene and functional performance.

We believe that our systems and services are truly unique, delivering unparalleled benefits to everyone involved in project delivery or subsequent operation.

ACO hygienic drainage fulfils stringent hygienic requirements to prevent harmful bacterial contamination. We apply the relevant hygienic design principles reserved for food contact surfaces EN 1672, EN ISO 14159 and EHEDG document to the channel design.

ACO channel hygienic features:

- Fully drainable
- Internal radii equal or larger than 3 mm
- Hygienic joints
- Edge infill
- Stainless steel grade min. AISI 304
- Fully pickled and passivated

ACO channel

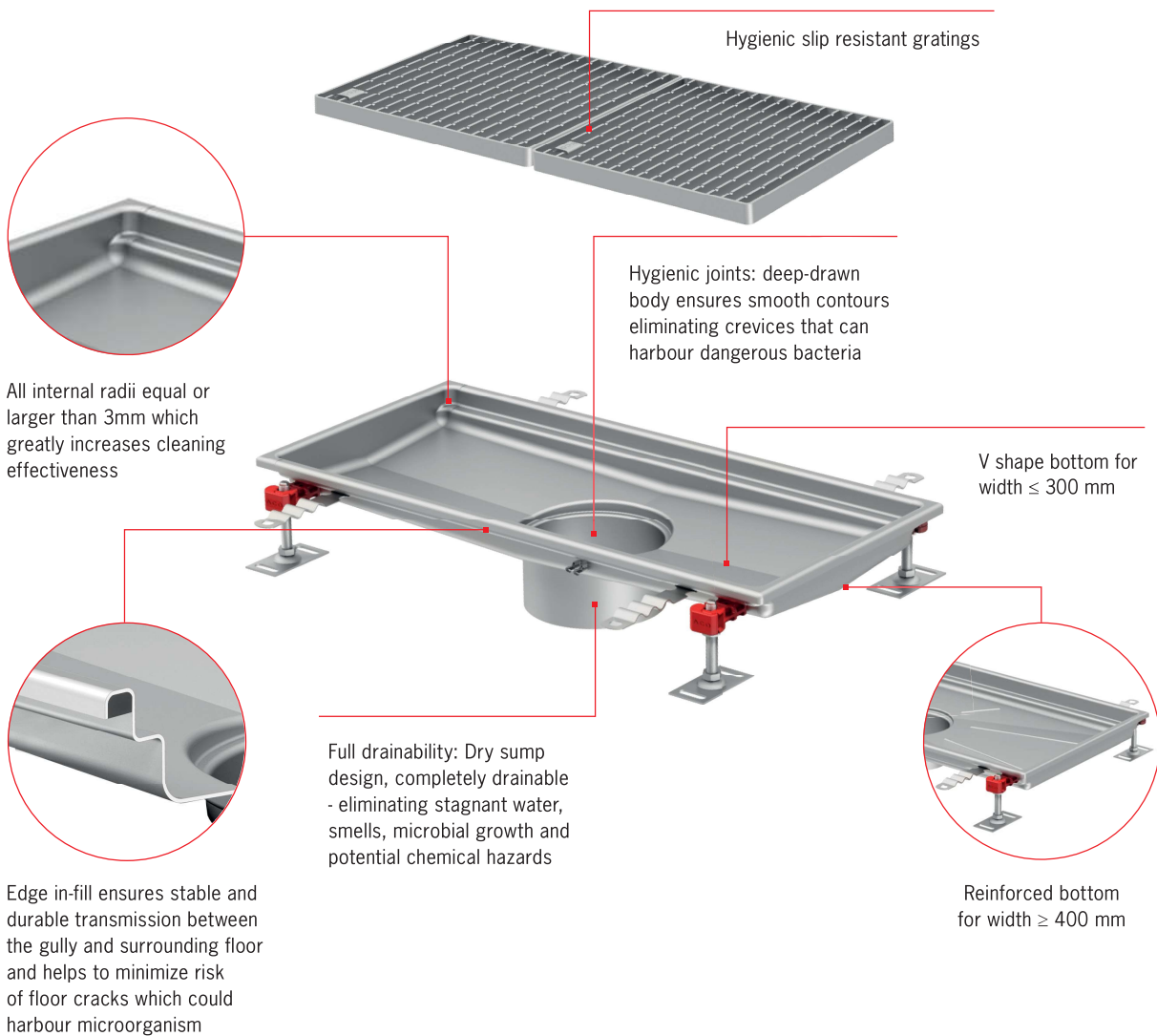

All internal radii equal or larger than 3mm which greatly increases cleaning effectiveness

Edge in-fill ensures stable and durable transmission between the gully and surrounding floor and helps to minimize risk of floor cracks which could harbour microorganism

Full drainability: Dry sump design, completely drainable - eliminating stagnant water, smells, microbial growth and potential chemical hazards

Hygienic joints: deep-drawn body ensures smooth contours eliminating crevices that can harbour dangerous bacteria

V shape bottom for width ≤ 300 mm

Reinforced bottom for width ≥ 400 mm

System overview

ACO channel



ACO box channel



ACO slot channel



ACO modular box channel

- 1** Gratings
- 2** Silt basket
- 3** Friction ring
- 4** Foul air trap
- 5** Foul air trap support
- 6** ACO gully



**ACO gully
with accessories**

ACO channel

Introduction

ACO box channel portfolio

The ACO box channel range includes channels for all common applications and all common floor types (concrete, tiles, resin or vinyl). The ACO box channel portfolio is designed with respect to hygienic design requirements. Selecting a channel from the range is easy.

The unique variability of the whole portfolio makes it easy to choose a channel that suits a customer's specific needs. Channel length, depth and outlet position are just a few of the parameters which can be varied and, regardless of the variations specified, there is no impact on delivery lead times.

ACO box channel ordering

The dimensions of the ACO box channel can be easily specified in respect of project requirements. To specify the channel please use the Customization template (see page 102) which will help you to identify the information you need, or contact our Sales/Technical department.

ACO box channels with fixed dimensions are also available. These dimensions are a selection of most frequently sold ACO box channels. Please see page 85 where you can find the overview.

ACO box channel customization

In addition all ACO box channels can be designed with:

- Special outlet position
- Special depth
- Special slope
- Special channel width
- L-shape and T-shape lay out
- Special side inlets

To ask for customised ACO box channel, please contact our Sales/technical department. Please take into consideration that ACO channel customization could decrease the number of hygienic design features.

ACO box channel system overview

ACO box channel - fixed height solution



ACO hygienic box channel
Standard edge

ACO hygienic box channel
Extended edge

ACO vinyl box channel

ACO box channel - telescopic solution



ACO hygienic box channel
Standard edge

ACO hygienic box channel
Extended edge

ACO vinyl box channel



ACO hygienic gully
with accessories

ACO hygienic box channel - standard articles

Product information

The dimensions of the ACO hygienic box channel for concrete, tiles and resin floor can be easily specified in respect of project requirements or easily chosen from predefined fixed dimensions.

HygieneFirst features

- Hygienic design following EN 1672, EN ISO 14159 and EHEDG document No. 8, 13 and 44
- Available in 1.4301 (304) or 1.4404 (316L) grades of stainless steel
- Material thickness 1.5 mm
- Fully removable and easily cleanable stainless steel foul air trap (FAT)
- Rubber edge infill
- Fully pickled and passivated
- Minimal longitudinal slope 1%
- Min. sectional slope 5°
- Material thickness 1.5 mm
- Hygienic gratings with slip resistance available
- Protective cover available. See page 230 for more details
- Tested and certified according to EN 1253-1
- V-shape bottom for width < 300 mm
- Reinforced bottom for width > 400 mm
- Outlet without deformation
- Easy and secure telescopic connection with gully
- Adjustable EasyFix levelling feet 60-110 mm
- Anchors for fixing in concrete

Order information

Standard edge

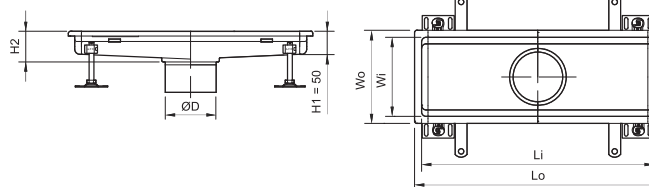

Extended edge

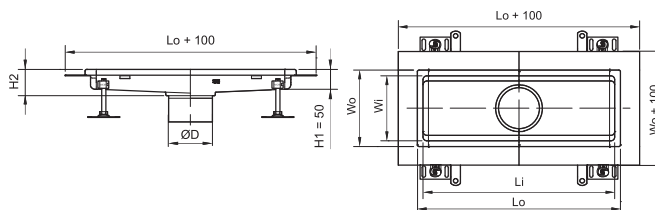

| Wo [mm] | Wi [mm] | Channel dimensions | | H2 [mm] | øD [mm] | Gully | Material | Standard edge | Extended edge |
|---------|---------|--------------------|---------|---------|---------|------------------------|----------|---------------|---------------|
| | | Lo [mm] | Li [mm] | | | | | Item number | Item number |
| 200 | 170 | 530 | 500 | 60 | 125 | ACO hygienic gully 142 | 1.4301 | 416584 | 416680 |
| | | 530 | 500 | | | | | 416602 | 416698 |
| | | 830 | 800 | | | | | 416585 | 416681 |
| | | 830 | 800 | | | | | 416603 | 416699 |
| | | 1030 | 1000 | | | | | 416586 | 416682 |
| | | 1030 | 1000 | | | | | 416604 | 416700 |
| | | 1230 | 1200 | | | | | 416587 | 416683 |
| | | 1230 | 1200 | | | | | 416605 | 416701 |
| | | 1530 | 1500 | | | | | 416588 | 416684 |
| | | 1530 | 1500 | | | | | 416606 | 416702 |
| | | 2030 | 2000 | | | | | 416589 | 416685 |
| | | 2030 | 2000 | | | | | 416607 | 416703 |

Order information

| Wo [mm] | Wi [mm] | Channel dimensions | | H2 [mm] | øD [mm] | Gully | Material | Standard edge | Extended edge | |
|------------|------------|--------------------|------------|------------|------------|------------------------------|------------------------------|---------------|---------------|---------------|
| | | Lo [mm] | Li [mm] | | | | | Item number | Item number | |
| 200 | 170 | 530 | 500 | 60 | 142 | ACO hygienic gully 157 | 1.4301 | 416590 | 416686 | |
| | | 530 | 500 | | | | | 1.4404 | 416608 | 416704 |
| | | 830 | 800 | | | | | 1.4301 | 416591 | 416687 |
| | | 830 | 800 | | | | | 1.4404 | 416609 | 416705 |
| | | 1030 | 1000 | | | | | 1.4301 | 416592 | 416688 |
| | | 1030 | 1000 | | | | | 1.4404 | 416610 | 416706 |
| | | 1230 | 1200 | | | | | 1.4301 | 416593 | 416689 |
| | | 1230 | 1200 | | | | | 1.4404 | 416611 | 416707 |
| | | 1530 | 1500 | | | | | 1.4301 | 416594 | 416690 |
| | | 1530 | 1500 | | | | | 1.4404 | 416612 | 416708 |
| | | 2030 | 2000 | | | | | 1.4301 | 416595 | 416691 |
| | | 2030 | 2000 | | | | | 1.4404 | 416613 | 416709 |
| 300 | 270 | 330 | 300 | 55 | 142 | ACO hygienic gully 157 | 1.4301 | 416614 | 416710 | |
| | | 330 | 300 | 60 | | | | 1.4404 | 416628 | 416724 |
| | | 630 | 600 | | | | | 1.4301 | 416615 | 416711 |
| | | 630 | 600 | 60 | | | | 1.4404 | 416629 | 416725 |
| | | 1030 | 1000 | | | | | 1.4301 | 416616 | 416712 |
| | | 1030 | 1000 | 60 | | | | 1.4404 | 416630 | 416726 |
| | | 1530 | 1500 | | | | | 1.4301 | 416617 | 416713 |
| | | 1530 | 1500 | 60 | | | | 1.4404 | 416631 | 416727 |
| | | 2030 | 2000 | | | | | 1.4301 | 416618 | 416714 |
| | | 2030 | 2000 | 60 | | | | 1.4404 | 416632 | 416728 |
| | | 3030 | 3000 | | | | | 1.4301 | 416619 | 416715 |
| | | 3030 | 3000 | 70 | | | | 1.4404 | 416633 | 416729 |
| | | 4030 | 4000 | | | | | 1.4301 | 416620 | 416716 |
| | | 4030 | 4000 | 80 | | | | 1.4404 | 416634 | 416730 |
| 300 | 270 | 330 | 300 | | 55 | 200 | ACO hygienic gully 218 | 1.4301 | 416621 | 416717 |
| | | 330 | 300 | 60 | 1.4404 | | | | 416635 | 416731 |
| | | 630 | 600 | | 1.4301 | | | | 416622 | 416718 |
| | | 630 | 600 | 60 | 1.4404 | | | | 416636 | 416732 |
| | | 1030 | 1000 | | 1.4301 | | | | 416623 | 416719 |
| | | 1030 | 1000 | 60 | 1.4404 | | | | 416637 | 416733 |
| | | 1530 | 1500 | | 1.4301 | | | | 416624 | 416720 |
| | | 1530 | 1500 | 60 | 1.4404 | | | | 416638 | 416734 |
| | | 2030 | 2000 | | 1.4301 | | | | 416625 | 416721 |
| | | 2030 | 2000 | 60 | 1.4404 | | | | 416639 | 416735 |
| | | 3030 | 3000 | | 1.4301 | | | | 416626 | 416722 |
| | | 3030 | 3000 | 70 | 1.4404 | | | | 416640 | 416736 |
| | | 4030 | 4000 | | 1.4301 | | | | 416627 | 416723 |
| | | 4030 | 4000 | 80 | 1.4404 | | | | 416641 | 416737 |
| 400 | 370 | 430 | 400 | | 60 | 142 | ACO hygienic gully 157 | 1.4301 | 416642 | 416738 |
| | | 430 | 400 | 1.4404 | | | | | 416648 | 416744 |
| | | 630 | 600 | 1.4301 | | | | | 416643 | 416739 |
| | | 630 | 600 | 1.4404 | | | | | 416649 | 416745 |
| | | 830 | 800 | 1.4301 | | | | | 416644 | 416740 |
| | | 830 | 800 | 1.4404 | | | | | 416650 | 416746 |
| 400 | 370 | 430 | 400 | 60 | 200 | ACO hygienic gully 218 | 1.4301 | 416645 | 416741 | |
| | | 430 | 400 | | | | | 1.4404 | 416651 | 416747 |
| | | 630 | 600 | | | | | 1.4301 | 416646 | 416742 |
| | | 630 | 600 | | | | | 1.4404 | 416652 | 416748 |
| | | 830 | 800 | | | | | 1.4301 | 416647 | 416743 |
| | | 830 | 800 | | | | | 1.4404 | 416653 | 416749 |

ACO channel

| Wo [mm] | Wi [mm] | Channel dimensions | | H2 [mm] | øD [mm] | Gully | Material | Standard edge | Extended edge |
|------------|------------|--------------------|------------|------------|------------|------------------------------|----------|---------------|---------------|
| | | Lo [mm] | Li [mm] | | | | | Item number | Item number |
| 500 | 470 | 530 | 500 | 65 | 142 | ACO hygienic gully 157 | 1.4301 | 416654 | 416750 |
| | | 530 | 500 | | | | 1.4404 | 416660 | 416756 |
| | | 830 | 800 | | | | 1.4301 | 416655 | 416751 |
| | | 830 | 800 | | | | 1.4404 | 416661 | 416757 |
| | | 1030 | 1000 | | | | 1.4301 | 416656 | 416752 |
| | | 1030 | 1000 | | | | 1.4404 | 416662 | 416758 |
| | | 530 | 500 | | | | 1.4301 | 416657 | 416753 |
| 500 | 470 | 530 | 500 | 65 | 200 | ACO hygienic gully 218 | 1.4404 | 416663 | 416759 |
| | | 830 | 800 | | | | 1.4301 | 416658 | 416754 |
| | | 830 | 800 | | | | 1.4404 | 416664 | 416760 |
| | | 1030 | 1000 | | | | 1.4301 | 416659 | 416755 |
| | | 1030 | 1000 | | | | 1.4404 | 416665 | 416761 |
| | | 630 | 600 | | | | 1.4301 | 416666 | 416762 |
| 600 | 570 | 630 | 600 | 70 | 200 | ACO hygienic gully 218 | 1.4404 | 416669 | 416765 |
| | | 930 | 900 | | | | 1.4301 | 416667 | 416763 |
| | | 930 | 900 | | | | 1.4404 | 416670 | 416766 |
| | | 1230 | 1200 | | | | 1.4301 | 416668 | 416764 |
| | | 1230 | 1200 | | | | 1.4404 | 416671 | 416767 |
| | | 830 | 800 | | | | 1.4301 | 416672 | 416768 |
| 800 | 770 | 830 | 800 | 80 | 200 | ACO hygienic gully 218 | 1.4404 | 416673 | 416769 |

ACO hygienic box channel - semi-standard

Product information

The dimensions of the ACO hygienic box channel for concrete, tiles and resin floor can be easily specified in respect of project requirements.

HygieneFirst features

- Hygienic design following EN 1672, EN ISO 14159 and EHEDG document No. 8, 13 and 44
- Available in 1.4301 (304) or 1.4404 (316L) grades of stainless steel
- Fully removable and easily cleanable stainless steel foul air trap (FAT)
- Rubber edge infill
- Fully pickled and passivated
- Sectional slope of the channel bottom 5°
- Longitudinal slope of the channel bottom 1-5 %
- Material thickness 1.5 mm
- Hygienic gratings with slip resistance available
- Protective cover available. See page 230 for more details
- Tested and certified according to EN 1253-1
- V-shape bottom for width < 300 mm
- Reinforced bottom for width > 400 mm
- Length - up to customer request
- Height - variable 50-200
- Outlet position variable in longitudinal axis
- Standardized widths
- Easy and secure telescopic connection with gully
- Adjustable EasyFix levelling feet 60-110 mm
- Anchors for fixing in concrete

Order information

Standard edge

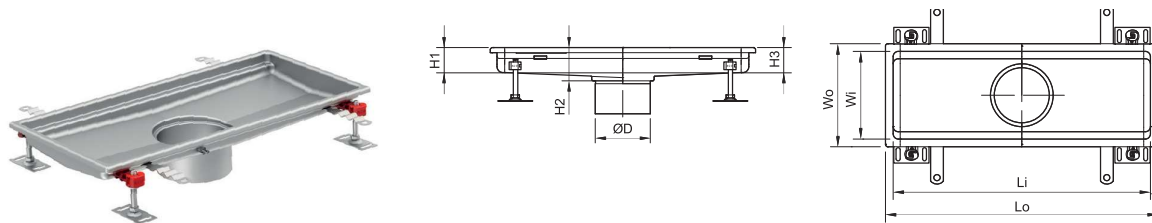

Extended edge

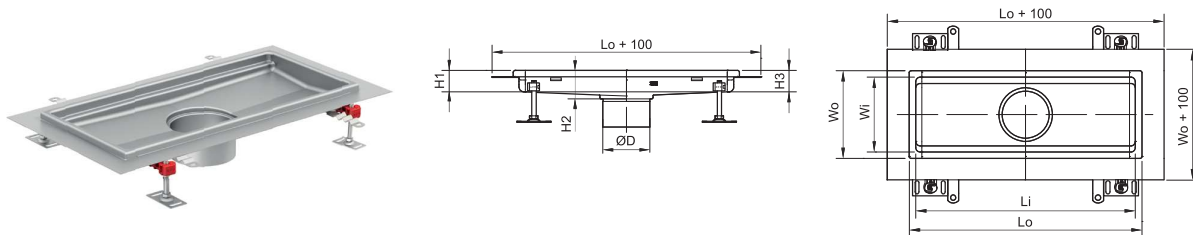

| External (overall) width Wo [mm] | Internal (grating) width Wi [mm] | Length of channel Lo | Height at outlet of channel H2 | Height at end of channel H1 and H3 |
|-------------------------------------|-------------------------------------|-------------------------|-----------------------------------|---------------------------------------|
| 200 | 170 | Variable * | 50-200 | 50, 80, 110, 140 |
| 300 | 270 | | | |
| 400 | 370 | | | |
| 500 | 470 | | | |
| 600 | 570 | | | |
| 800 | 770 | | | |

* Long channels over 6m are standard divided in 6m sections with transport joints.

In case of one piece channel requirement, channels have to be welded on site. Please contact our Sales/Technical department.

ACO vinyl box channel - standard articles

Product information

The dimensions of the ACO vinyl box channel can be specified in respect of project requirements or easily chosen from predefined fixed dimensions.

- Fully compliant to EN 1253-1
- Available in 1.4301 (304) or 1.4404 (316L) grades of stainless steel, pickled and passivated
- Material thickness 1.5 mm
- Easy and secure telescopic connection with gully
- Adjustable EasyFix levelling feet 60-110 mm
- Anchors for fixing in concrete
- Protective cover available.
See page 230 for more details

Order information

Vinyl edge

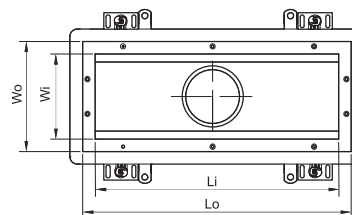
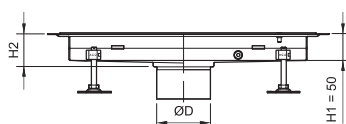

| Wo [mm] | Wi [mm] | Channel dimensions | | H2 [mm] | øD [mm] | Gully | Material | Vinyl edge |
|---------|---------|--------------------|---------|---------|---------|------------------------|----------|---------------|
| | | Lo [mm] | Li [mm] | | | | | Item number |
| 220 | 170 | 550 | 500 | 60 | 125 | ACO hygienic gully 142 | 1.4301 | 413358 |
| | | 550 | 500 | | | | | 413376 |
| | | 850 | 800 | | | | | 413359 |
| | | 850 | 800 | | | | | 413377 |
| | | 1050 | 1000 | | | | | 413360 |
| | | 1050 | 1000 | | | | | 413378 |
| | | 1250 | 1200 | | | | | 413361 |
| | | 1250 | 1200 | | | | | 413379 |
| | | 1550 | 1500 | | | | | 413362 |
| | | 1550 | 1500 | | | | | 413380 |
| | | 2050 | 2000 | | | | | 413363 |
| | | 2050 | 2000 | | | | | 413381 |
| 220 | 170 | 550 | 500 | 60 | 142 | ACO hygienic gully 157 | 1.4301 | 413364 |
| | | 550 | 500 | | | | | 413382 |
| | | 850 | 800 | | | | | 413365 |
| | | 850 | 800 | | | | | 413383 |
| | | 1050 | 1000 | | | | | 413366 |
| | | 1050 | 1000 | | | | | 413384 |
| | | 1250 | 1200 | | | | | 413367 |
| | | 1250 | 1200 | | | | | 413385 |
| | | 1550 | 1500 | | | | | 413368 |
| | | 1550 | 1500 | | | | | 413386 |
| | | 2050 | 2000 | | | | | 413369 |
| | | 2050 | 2000 | | | | | 413387 |

ACO box channel
ACO vinyl box channel - standard articles

| Wo [mm] | Wi [mm] | Channel dimensions | | H2 [mm] | øD [mm] | Gully | Material | Vinyl edge Item number |
|------------|------------|--------------------|------------|------------|------------|------------------------------|----------|---------------------------|
| | | Lo [mm] | Li [mm] | | | | | |
| 320 | 270 | 350 | 300 | 60 | 142 | ACO hygienic gully 157 | 1.4301 | 413388 |
| | | 350 | 300 | | | | 1.4404 | 413402 |
| | | 650 | 600 | | | | 1.4301 | 413389 |
| | | 650 | 600 | | | | 1.4404 | 413403 |
| | | 1050 | 1000 | | | | 1.4301 | 413390 |
| | | 1050 | 1000 | | | | 1.4404 | 413404 |
| | | 1550 | 1500 | | | | 1.4301 | 413391 |
| | | 1550 | 1500 | | | | 1.4404 | 413405 |
| | | 2050 | 2000 | | | | 1.4301 | 413392 |
| | | 2050 | 2000 | | | | 1.4404 | 413406 |
| | | 3050 | 3000 | 70 | | | 1.4301 | 413393 |
| | | 3050 | 3000 | | | | 1.4404 | 413407 |
| | | 4050 | 4000 | | | | 80 | 1.4301 |
| | | 4050 | 4000 | 1.4404 | | | | 413408 |
| 320 | 270 | 350 | 300 | 60 | 200 | ACO hygienic gully 218 | 1.4301 | 413395 |
| | | 350 | 300 | | | | 1.4404 | 413409 |
| | | 650 | 600 | | | | 1.4301 | 413396 |
| | | 650 | 600 | | | | 1.4404 | 413410 |
| | | 1050 | 1000 | | | | 1.4301 | 413397 |
| | | 1050 | 1000 | | | | 1.4404 | 413411 |
| | | 1550 | 1500 | | | | 1.4301 | 413398 |
| | | 1550 | 1500 | | | | 1.4404 | 413412 |
| | | 2050 | 2000 | | | | 1.4301 | 413399 |
| | | 2050 | 2000 | | | | 1.4404 | 413413 |
| | | 3050 | 3000 | 70 | | | 1.4301 | 413400 |
| | | 3050 | 3000 | | | | 1.4404 | 413414 |
| | | 4050 | 4000 | | | | 80 | 1.4301 |
| | | 4050 | 4000 | 1.4404 | | | | 413415 |
| 420 | 370 | 450 | 400 | 60 | 142 | ACO hygienic gully 157 | 1.4301 | 413416 |
| | | 450 | 400 | | | | 1.4404 | 413422 |
| | | 650 | 600 | | | | 1.4301 | 413417 |
| | | 650 | 600 | | | | 1.4404 | 413423 |
| | | 850 | 800 | | | | 1.4301 | 413418 |
| | | 850 | 800 | | | | 1.4404 | 413424 |
| 420 | 370 | 450 | 400 | 60 | 200 | ACO hygienic gully 218 | 1.4301 | 413419 |
| | | 450 | 400 | | | | 1.4404 | 413425 |
| | | 650 | 600 | | | | 1.4301 | 413420 |
| | | 650 | 600 | | | | 1.4404 | 413426 |
| | | 850 | 800 | | | | 1.4301 | 413421 |
| | | 850 | 800 | | | | 1.4404 | 413427 |
| 520 | 470 | 530 | 500 | 65 | 142 | ACO hygienic gully 157 | 1.4301 | 413428 |
| | | 530 | 500 | | | | 1.4404 | 413434 |
| | | 830 | 800 | | | | 1.4301 | 413429 |
| | | 830 | 800 | | | | 1.4404 | 413435 |
| | | 1030 | 1000 | | | | 1.4301 | 413430 |
| | | 1030 | 1000 | | | | 1.4404 | 413436 |
| 520 | 470 | 550 | 500 | 65 | 200 | ACO hygienic gully 218 | 1.4301 | 413431 |
| | | 550 | 500 | | | | 1.4404 | 413437 |
| | | 850 | 800 | | | | 1.4301 | 413432 |
| | | 850 | 800 | | | | 1.4404 | 413438 |
| | | 1050 | 1000 | | | | 1.4301 | 413433 |
| | | 1050 | 1000 | | | | 1.4404 | 413439 |
| 620 | 570 | 650 | 600 | 70 | 200 | ACO hygienic gully 218 | 1.4301 | 413440 |
| | | 650 | 600 | | | | 1.4404 | 413443 |
| | | 950 | 900 | | | | 1.4301 | 413441 |
| | | 950 | 900 | | | | 1.4404 | 413444 |
| | | 1250 | 1200 | | | | 1.4301 | 413442 |
| | | 1250 | 1200 | | | | 1.4404 | 413445 |
| 820 | 770 | 850 | 800 | 80 | 200 | ACO hygienic gully 218 | 1.4301 | 413446 |
| | | | | | | | 1.4404 | 413447 |

ACO channel

ACO vinyl box channel - semi-standard

Product information

The dimensions of the ACO vinyl box channel can be easily specified in respect of project requirements.

- Fully compliant to EN 1253-1
- Available in 1.4301 (304) or 1.4404 (316L) grades of stainless steel, pickled and passivated
- Material thickness 1.5 mm
- Height variable 50-200 mm
- Length – up to customer request
- Standardized widths
- Outlet position central or variable in longitudinal axis
- Longitudinal slopes of the channel bottom 1-5 %
- Adjustable EasyFix levelling feet 60-110 mm
- Anchors for fixing in concrete
- Protective cover available. See page 230 for more details

Order information

Vinyl edge

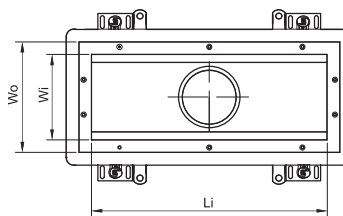
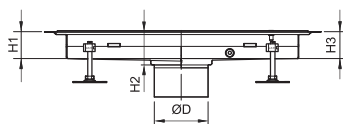

| External (overall) width Wo [mm] | Internal (grating) width Wi [mm] | Length of channel Li | Height at outlet of channel H2 | Height at end of channel H1 and H3 |
|-------------------------------------|-------------------------------------|-------------------------|-----------------------------------|---------------------------------------|
| 230 | 170 | Variable * | 50-200 | 50, 80, 110, 140 |
| 330 | 270 | | | |
| 430 | 370 | | | |
| 530 | 470 | | | |
| 630 | 570 | | | |
| 830 | 870 | | | |

* Long channels over 6m are standard divided in 6m sections with transport joints.

In case of requirements one piece channel, channels have to be welded on site. Please contact our Sales/Technical department.

ACO hygienic cast grating

Product information

HygieneFirst features

- Hygienic design following EN 1672, EN ISO 14159 and EHEDG document No. 8, 13 and 44
- Available in 1.4301 (304) grade of stainless steel
- Fully pickled and passivated
- Electropolished surface
- Frameless design for optimum drainability and cleanliness
- Tested and certified according to EN 1253-1
- Range of gratings suitable for load class M 125 (EN 1253-1)
- Slip resistant
 - Low potential for slip according to BS 7976-2,
 - R13 according to DIN 51130

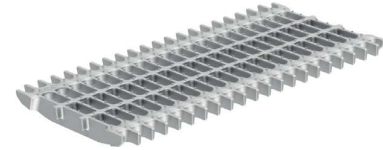

Order information - Load class M 125

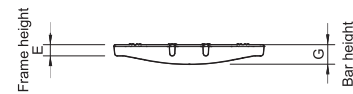
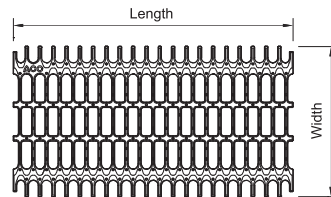
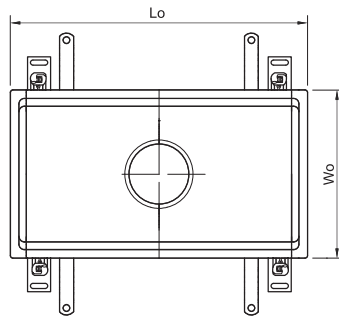

| Channel dimension | | Grating dimension | | | | Material | Item number | Quantity to fill channel |
|-------------------|---------|---------------------|-------------------|------------|-------------|----------|---------------|--------------------------|
| Wo [mm] | Lo [mm] | Frame height E [mm] | Bar height G [mm] | Width [mm] | Length [mm] | | | |
| 200 | 530 | 20 | 30 | 168 | 499 | 1.4301 | 416947 | 1 |
| | 830 | 20 | 30 | 168 | 398 | 1.4301 | 416948 | 2 |
| | 1030 | 20 | 30 | 168 | 499 | 1.4301 | 416947 | 2 |
| | 1230 | 20 | 30 | 168 | 398 | 1.4301 | 416948 | 3 |
| | 1530 | 20 | 30 | 168 | 499 | 1.4301 | 416947 | 3 |
| | 2030 | 20 | 30 | 168 | 499 | 1.4301 | 416947 | 4 |
| 300 | 330 | 20 | 30 | 268 | 298 | 1.4301 | 416946 | 1 |
| | 630 | 20 | 30 | 268 | 298 | 1.4301 | 416946 | 2 |
| | 1030 | 20 | 30 | 268 | 499 | 1.4301 | 416945 | 2 |
| | 1530 | 20 | 30 | 268 | 499 | 1.4301 | 416945 | 3 |
| | 2030 | 20 | 30 | 268 | 499 | 1.4301 | 416945 | 4 |
| | 3030 | 20 | 30 | 268 | 499 | 1.4301 | 416945 | 6 |
| | 4030 | 20 | 30 | 268 | 499 | 1.4301 | 416945 | 8 |

ACO hygienic ladder grating

Product information

HygieneFirst features

- Hygienic design following EN 1672, EN ISO 14159 and EHEDG document No. 8, 13 and 44
- Fully pickled and passivated
- Electropolished surface
- Registered logo design allows for easy manipulation during cleaning

- Range of gratings suitable for load classes R 50, M 125 and N 250 (EN 1253-1)
- High flow capacity
- Rounded corners
- Slip resistant
 - Low potential for slip according to BS 7976-2,
 - R11 according to DIN 51130



Order information - Load class R 50

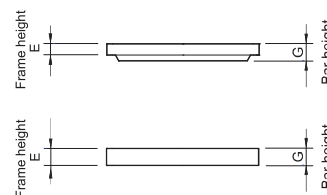
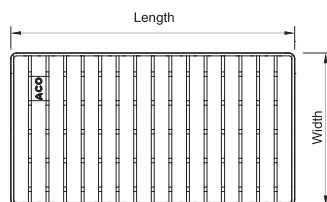
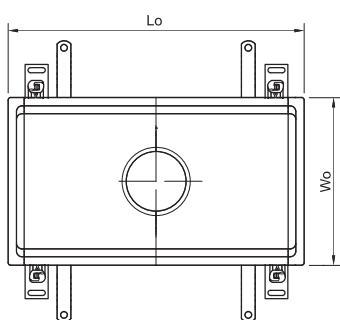

| Channel dimension | | Grating dimension | | | | Material | Item number | Quantity to fill channel |
|-------------------|---------|---------------------|-------------------|------------|-------------|----------|---------------|--------------------------|
| Wo [mm] | Lo [mm] | Frame height E [mm] | Bar height G [mm] | Width [mm] | Length [mm] | | | |
| 200 | 530 | 20 | 20 | 168 | 499 | 1.4301 | 416802 | 1 |
| | | | | | | 1.4404 | 416803 | |
| | 830 | 20 | 20 | 168 | 398 | 1.4301 | 416808 | 2 |
| | | | | | | 1.4404 | 416809 | |
| | 1030 | 20 | 20 | 168 | 499 | 1.4301 | 416802 | 2 |
| | | | | | | 1.4404 | 416803 | |
| | 1230 | 20 | 20 | 168 | 398 | 1.4301 | 416808 | 3 |
| | | | | | | 1.4404 | 416809 | |
| | 1530 | 20 | 20 | 168 | 499 | 1.4301 | 416802 | 3 |
| | | | | | | 1.4404 | 416803 | |
| | 2030 | 20 | 20 | 168 | 499 | 1.4301 | 416802 | 4 |
| | | | | | | 1.4404 | 416803 | |

| Channel dimension | | Grating dimension | | | | Material | Item number | Quantity to fill channel |
|-------------------|---------|---------------------|-------------------|------------|-------------|---------------|---------------|--------------------------|
| Wo [mm] | Lo [mm] | Frame height E [mm] | Bar height G [mm] | Width [mm] | Length [mm] | | | |
| 300 | 330 | 20 | 20 | 268 | 298 | 1.4301 | 416812 | 1 |
| | | | | | | 1.4404 | 416813 | |
| | 630 | 20 | 20 | 268 | 298 | 1.4301 | 416812 | 2 |
| | | | | | | 1.4404 | 416813 | |
| | 1030 | 20 | 20 | 268 | 499 | 1.4301 | 416814 | 2 |
| | | | | | | 1.4404 | 416815 | |
| | 1530 | 20 | 20 | 268 | 499 | 1.4301 | 416814 | 3 |
| | | | | | | 1.4404 | 416815 | |
| | 2030 | 20 | 20 | 268 | 499 | 1.4301 | 416814 | 4 |
| | | | | | | 1.4404 | 416815 | |
| 3030 | 20 | 20 | 268 | 499 | 1.4301 | 416814 | 6 | |
| | | | | | 1.4404 | 416815 | | |
| 4030 | 20 | 20 | 268 | 499 | 1.4301 | 416814 | 8 | |
| | | | | | 1.4404 | 416815 | | |
| 400 | 430 | 30 | 30 | 368 | 398 | 1.4301 | 416820 | 1 |
| | | | | | | 1.4404 | 416821 | |
| | 630 | 30 | 30 | 368 | 598 | 1.4301 | 416822 | 1 |
| | | | | | | 1.4404 | 416823 | |
| 830 | 30 | 30 | 368 | 398 | 1.4301 | 416820 | 2 | |
| | | | | | 1.4404 | 416821 | | |
| 500 | 530 | 30 | 30 | 468 | 499 | 1.4301 | 416828 | 1 |
| | | | | | | 1.4404 | 416829 | |
| | 830 | 30 | 30 | 468 | 398 | 1.4301 | 416830 | 2 |
| | | | | | | 1.4404 | 416831 | |
| 1030 | 30 | 30 | 468 | 499 | 1.4301 | 416828 | 2 | |
| | | | | | 1.4404 | 416829 | | |
| 600 | 630 | 30 | 30 | 568 | 298 | 1.4301 | 416838 | 2 |
| | | | | | | 1.4404 | 416839 | |
| | 930 | 30 | 30 | 568 | 298 | 1.4301 | 416838 | 3 |
| | | | | | | 1.4404 | 416839 | |
| 1230 | 30 | 30 | 568 | 298 | 1.4301 | 416838 | 4 | |
| | | | | | 1.4404 | 416839 | | |
| 800 | 830 | 30 | 30 | 768 | 398 | 1.4301 | 416842 | 2 |
| | | | | | | 1.4404 | 416843 | |

ACO channel

Order information - Load class M 125

ACO channel

| Channel dimension | | Grating dimension | | | | Material | Item number | Quantity to fill channel |
|-------------------|---------|---------------------|-------------------|------------|-------------|---------------|---------------|--------------------------|
| Wo [mm] | Lo [mm] | Frame height E [mm] | Bar height G [mm] | Width [mm] | Length [mm] | | | |
| 200 | 530 | 20 | 30 | 168 | 499 | 1.4301 | 416804 | 1 |
| | | | | | | 1.4404 | 416805 | |
| | 830 | 20 | 30 | 168 | 398 | 1.4301 | 416810 | 2 |
| | | | | | | 1.4404 | 416811 | |
| | 1030 | 20 | 30 | 168 | 499 | 1.4301 | 416804 | 2 |
| | | | | | | 1.4404 | 416805 | |
| | 1230 | 20 | 30 | 168 | 398 | 1.4301 | 416810 | 3 |
| | | | | | | 1.4404 | 416811 | |
| | 1530 | 20 | 30 | 168 | 499 | 1.4301 | 416804 | 3 |
| | | | | | | 1.4404 | 416805 | |
| | 2030 | 20 | 30 | 168 | 499 | 1.4301 | 416804 | 4 |
| | | | | | | 1.4404 | 416805 | |
| 300 | 330 | 20 | 30 | 268 | 298 | 1.4301 | 416816 | 1 |
| | | | | | | 1.4404 | 416817 | |
| | 630 | 20 | 30 | 268 | 298 | 1.4301 | 416816 | 2 |
| | | | | | | 1.4404 | 416817 | |
| | 1030 | 20 | 30 | 268 | 499 | 1.4301 | 416818 | 2 |
| | | | | | | 1.4404 | 416819 | |
| | 1530 | 20 | 30 | 268 | 499 | 1.4301 | 416818 | 3 |
| | | | | | | 1.4404 | 416819 | |
| | 2030 | 20 | 30 | 268 | 499 | 1.4301 | 416818 | 4 |
| | | | | | | 1.4404 | 416819 | |
| | 3030 | 20 | 30 | 268 | 499 | 1.4301 | 416818 | 6 |
| | | | | | | 1.4404 | 416819 | |
| 4030 | 20 | 30 | 268 | 499 | 1.4301 | 416818 | 8 | |
| | | | | | 1.4404 | 416819 | | |
| 400 | 430 | 30 | 30 | 368 | 398 | 1.4301 | 416824 | 1 |
| | | | | | | 1.4404 | 416825 | |
| | 630 | 30 | 30 | 368 | 598 | 1.4301 | 416826 | 1 |
| | | | | | | 1.4404 | 416827 | |
| | 830 | 30 | 30 | 368 | 398 | 1.4301 | 416824 | 2 |
| | | | | | | 1.4404 | 416825 | |
| 500 | 530 | 30 | 30 | 468 | 499 | 1.4301 | 416832 | 1 |
| | | | | | | 1.4404 | 416833 | |
| | 830 | 30 | 30 | 468 | 398 | 1.4301 | 416834 | 2 |
| | | | | | | 1.4404 | 416835 | |
| | 1030 | 30 | 30 | 468 | 499 | 1.4301 | 416832 | 2 |
| | | | | | | 1.4404 | 416833 | |

Order information - Load class N 250

| Channel dimension | | Grating dimension | | | | Material | Item number | Quantity to fill channel |
|-------------------|---------|---------------------|-------------------|------------|-------------|----------|---------------|--------------------------|
| Wo [mm] | Lo [mm] | Frame height E [mm] | Bar height G [mm] | Width [mm] | Length [mm] | | | |
| 200 | 530 | 20 | 30 | 168 | 499 | 1.4301 | 416844 | 1 |
| | | | | | | 1.4404 | 416845 | |
| | 830 | 20 | 30 | 168 | 398 | 1.4301 | 416846 | 2 |
| | | | | | | 1.4404 | 416847 | |
| | 1030 | 20 | 30 | 168 | 499 | 1.4301 | 416844 | 2 |
| | | | | | | 1.4404 | 416845 | |
| | 1230 | 20 | 30 | 168 | 398 | 1.4301 | 416846 | 3 |
| | | | | | | 1.4404 | 416847 | |
| | 1530 | 20 | 30 | 168 | 499 | 1.4301 | 416844 | 3 |
| | | | | | | 1.4404 | 416845 | |
| | 2030 | 20 | 30 | 168 | 499 | 1.4301 | 416844 | 4 |
| | | | | | | 1.4404 | 416845 | |
| 300 | 330 | 20 | 30 | 268 | 298 | 1.4301 | 416850 | 1 |
| | | | | | | 1.4404 | 416851 | |
| | 630 | 20 | 30 | 268 | 298 | 1.4301 | 416850 | 2 |
| | | | | | | 1.4404 | 416851 | |
| | 1030 | 20 | 30 | 268 | 499 | 1.4301 | 416848 | 2 |
| | | | | | | 1.4404 | 416849 | |
| | 1530 | 20 | 30 | 268 | 499 | 1.4301 | 416848 | 3 |
| | | | | | | 1.4404 | 416849 | |
| | 2030 | 20 | 30 | 268 | 499 | 1.4301 | 416848 | 4 |
| | | | | | | 1.4404 | 416849 | |
| | 3030 | 20 | 30 | 268 | 499 | 1.4301 | 416848 | 6 |
| | | | | | | 1.4404 | 416849 | |
| | 4030 | 20 | 30 | 268 | 499 | 1.4301 | 416848 | 8 |
| | | | | | | 1.4404 | 416849 | |

ACO channel

ACO mesh grating

Product information

- ACO mesh grating with slip resistant finish
- Tested and certified according to EN 1253-1
- Range of gratings suitable to load class L 15 (EN 1253-1)
- Surface - electropolished
- High flow capacity of grates
- Rounded corners
- Slip resistant
- Slip resistant low potential for slip according to BS 7976-2,
- R11 according to DIN 51130



Order information - Load class L 15

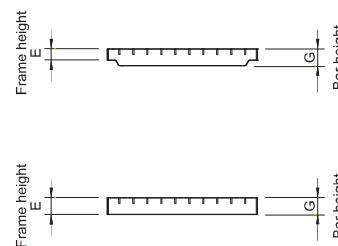
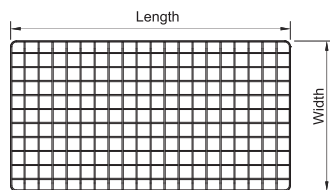
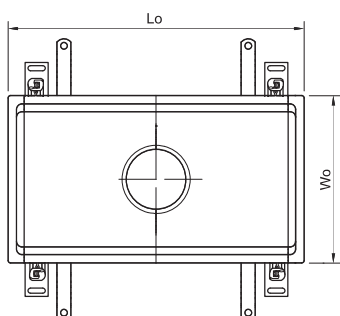

| Channel dimension | | Grating dimension | | | | Material | Item number | Quantity to fill channel |
|-------------------|---------|---------------------|-------------------|------------|-------------|----------|---------------|--------------------------|
| Wo [mm] | Lo [mm] | Frame height E [mm] | Bar height G [mm] | Width [mm] | Length [mm] | | | |
| 200 | 530 | 20 | 30 | 168 | 499 | 1.4301 | 416860 | 1 |
| | | | | | | 1.4404 | 416861 | |
| | 830 | 20 | 30 | 168 | 398 | 1.4301 | 416862 | 2 |
| | | | | | | 1.4404 | 416863 | |
| | 1030 | 20 | 30 | 168 | 499 | 1.4301 | 416860 | 2 |
| | | | | | | 1.4404 | 416861 | |
| | 1230 | 20 | 30 | 168 | 398 | 1.4301 | 416862 | 3 |
| | | | | | | 1.4404 | 416863 | |
| | 1530 | 20 | 30 | 168 | 499 | 1.4301 | 416860 | 3 |
| | | | | | | 1.4404 | 416861 | |
| | 2030 | 20 | 30 | 168 | 499 | 1.4301 | 416860 | 4 |
| | | | | | | 1.4404 | 416861 | |

| Channel dimension | | Grating dimension | | | | Material | Item number | Quantity to fill channel |
|-------------------|---------|---------------------|-------------------|------------|-------------|---------------|---------------|--------------------------|
| Wo [mm] | Lo [mm] | Frame height E [mm] | Bar height G [mm] | Width [mm] | Length [mm] | | | |
| 300 | 330 | 20 | 30 | 268 | 298 | 1.4301 | 416864 | 1 |
| | | | | | | 1.4404 | 416865 | |
| | 630 | 20 | 30 | 268 | 298 | 1.4301 | 416864 | 2 |
| | | | | | | 1.4404 | 416865 | |
| | 1030 | 20 | 30 | 268 | 499 | 1.4301 | 416866 | 2 |
| | | | | | | 1.4404 | 416867 | |
| | 1530 | 20 | 30 | 268 | 499 | 1.4301 | 416866 | 3 |
| | | | | | | 1.4404 | 416867 | |
| | 2030 | 20 | 30 | 268 | 499 | 1.4301 | 416866 | 4 |
| | | | | | | 1.4404 | 416867 | |
| 3030 | 20 | 30 | 268 | 499 | 1.4301 | 416866 | 6 | |
| | | | | | 1.4404 | 416867 | | |
| 4030 | 20 | 30 | 268 | 499 | 1.4301 | 416866 | 8 | |
| | | | | | 1.4404 | 416867 | | |
| 400 | 430 | 30 | 30 | 368 | 398 | 1.4301 | 416868 | 1 |
| | | | | | | 1.4404 | 416869 | |
| | 630 | 30 | 30 | 368 | 598 | 1.4301 | 416870 | 1 |
| | | | | | | 1.4404 | 416871 | |
| 830 | 30 | 30 | 368 | 398 | 1.4301 | 416868 | 2 | |
| | | | | | 1.4404 | 416869 | | |
| 500 | 530 | 30 | 30 | 468 | 499 | 1.4301 | 416872 | 1 |
| | | | | | | 1.4404 | 416873 | |
| | 830 | 30 | 30 | 468 | 398 | 1.4301 | 416874 | 2 |
| | | | | | | 1.4404 | 416875 | |
| 1030 | 30 | 30 | 468 | 499 | 1.4301 | 416872 | 2 | |
| | | | | | 1.4404 | 416873 | | |
| 600 | 630 | 30 | 30 | 568 | 298 | 1.4301 | 416876 | 2 |
| | | | | | | 1.4404 | 416877 | |
| | 930 | 30 | 30 | 568 | 298 | 1.4301 | 416876 | 3 |
| | | | | | | 1.4404 | 416877 | |
| 1230 | 30 | 30 | 568 | 298 | 1.4301 | 416876 | 4 | |
| | | | | | 1.4404 | 416877 | | |
| 800 | 830 | 30 | 30 | 768 | 398 | 1.4301 | 416878 | 2 |
| | | | | | | 1.4404 | 416879 | |

ACO channel

Accessories for ACO hygienic box channel

Silt baskets for ACO hygienic box channel

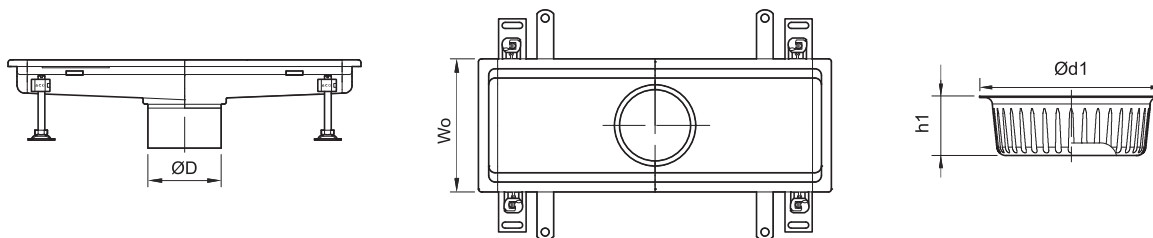

| Channel dimension | | Direction of gully outlet | Silt basket dimension | | Capacity [l] | Material | Item number |
|------------------------------------|---|---------------------------|-----------------------|---------|--------------|---------------|---------------|
| Width W ₀ [mm] | Outlet ØD [mm] | | Ød1 [mm] | h1 [mm] | | | |
| 200, 300, 400, 500, 600, 800 | 125 | vertical, horizontal | 142 | 45 | 0.4 | 1.4301 | 416900 |
| | | | | | | 1.4404 | 416901 |
| 200 | 142 | vertical | 142 | 45 | 0.4 | 1.4301 | 416900 |
| | | | | | | 1.4404 | 416901 |
| | horizontal | 142 | 25 | 0.3 | 1.4301 | 416902 | |
| | | | | | 1.4404 | 416903 | |
| welded with ACO hygienic gully 142 | vertical, horizontal | 142 | 25 | 0.3 | 1.4301 | 416902 | |
| | | | | | 1.4404 | 416903 | |
| 300, 400, 500, 600, 800 | 142 or welded with ACO hygienic gully 157 | vertical | 159 | 50 | 0.6 | 1.4301 | 416904 |
| | | | | | | 1.4404 | 416905 |
| | horizontal | 159 | 26 | 0.3 | 1.4301 | 416906 | |
| | | | | | 1.4404 | 416907 | |
| 300, 400, 500, 600, 800 | 200 or welded with ACO hygienic gully 218 | vertical | 222 | 50 | 1.4 | 1.4301 | 416908 |
| | | | | | | 1.4404 | 416909 |
| | horizontal | 222 | 26 | 0.7 | 1.4301 | 416910 | |
| | | | | | 1.4404 | 416911 | |

Notes

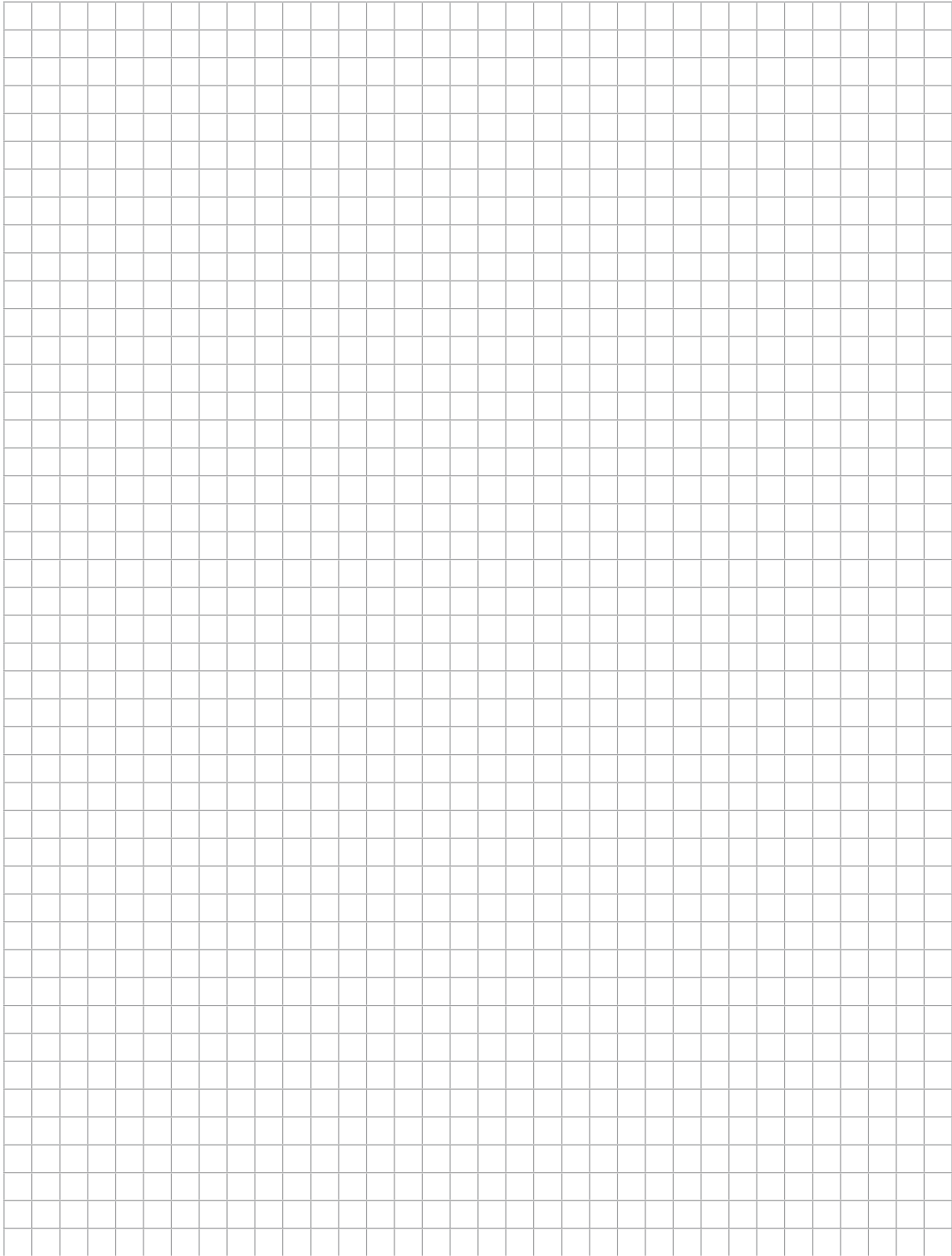

ACO customized box channel

Product information

The dimensions of the ACO customized box channel for concrete, tiles and resin floor can be easily specified in respect of project requirements.

- Available in 1.4301 (304) or 1.4404 (316L) grades of stainless steel, pickled and passivated
- Material thickness 1.5 mm or 2 mm
- Width – up to customer request
- Length – up to customer request
- Depth – up to customer request
- Variable shape of channel – T shape, L shape, ...
- Longitudinal slopes of the channel bottom 1-5 %
- Outlet position central or variable in longitudinal axis or eccentric outlet
- Adjustable EasyFix levelling feet
- Anchors for fixing in concrete
- Protective cover available for recommended channel widths. See page 230 for more details

Instruction

Please define channel dimensions by filling out required entry fields.

- Yellow entry fields highlight hygienic design options
- White entry fields highlight non-hygienic design options

Step 1 - Material

- Stainless steel grade 1.4301 (AISI 304)
- Stainless steel grade 1.4404 (AISI 316L)

Step 2 - Edge profiles



Standard

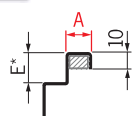

| A | 15 | Custom |
|--------------------|-------------------------------------|-----------------------------|
| Rubber edge infill | <input checked="" type="checkbox"/> | <input type="checkbox"/> |
| Steel edge infill | <input checked="" type="checkbox"/> | <input type="checkbox"/> ** |
| No edge infill | <input type="checkbox"/> | <input type="checkbox"/> |

Folded

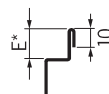

Extended

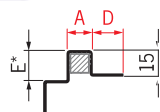

| A | 15 | Custom |
|--------------------|-------------------------------------|-----------------------------|
| Rubber edge infill | <input checked="" type="checkbox"/> | <input type="checkbox"/> |
| Steel edge infill | <input checked="" type="checkbox"/> | <input type="checkbox"/> ** |
| No edge infill | <input type="checkbox"/> | <input type="checkbox"/> |

Folded with flange

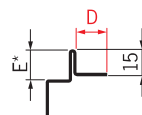

| D |
|--------|
| 50 |
| Custom |

L profile

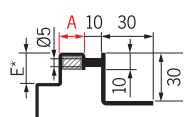

| A | 15 | Custom |
|--------------------|-------------------------------------|-----------------------------|
| Rubber edge infill | <input checked="" type="checkbox"/> | <input type="checkbox"/> |
| Steel edge infill | <input checked="" type="checkbox"/> | <input type="checkbox"/> ** |
| No edge infill | <input type="checkbox"/> | <input type="checkbox"/> |

Vinyl clamp

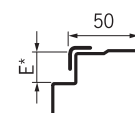

* Sitting height "E" for gratings is defined in step 7
 ** For hygienic solution, check with technical support

Step 3 - Channel dimensions

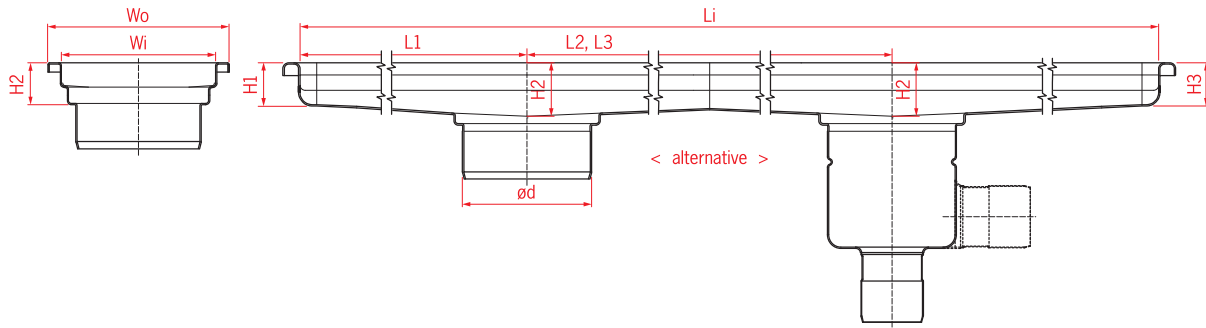

| Width overall/ internal W_o/W_i | |
|--------------------------------------|--------------------------|
| 200/170 | <input type="checkbox"/> |
| 300/270 | <input type="checkbox"/> |
| 400/370 | <input type="checkbox"/> |
| 500/470 | <input type="checkbox"/> |
| 600/570 | <input type="checkbox"/> |
| 800/770 | <input type="checkbox"/> |
| Customized width | <input type="text"/> |

| Channel bottom height | | |
|---|----|--------------------------|
| | H2 | <input type="checkbox"/> |
| Slope | | |
| No | | |
| Yes - slope 1% | | |
| Yes - height defined (If you require values below 50 mm, please contact technical support) | | |
| | H1 | <input type="checkbox"/> |
| | H3 | <input type="checkbox"/> |

| Channel lengths | | |
|-----------------|--|--------------------------|
| L_i | | <input type="checkbox"/> |
| L_1 | | <input type="checkbox"/> |
| L_2 | | <input type="checkbox"/> |
| L_3 | | <input type="checkbox"/> |
| L_4 | | <input type="checkbox"/> |

Step 4 - Gully

Welded gully

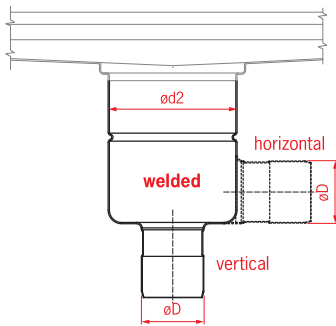

Telescopic gully

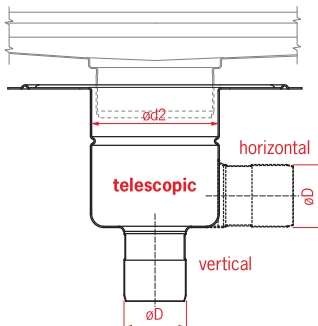

Location flange
(For telescopic gully only)

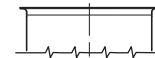

Bonding flange
(For telescopic gully only)



Clamping flange
(For telescopic gully only)

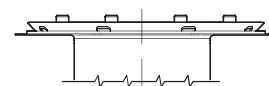

| Vertical outlet | | |
|--------------------------------|-------------------------------|--------------------------|
| Gully body diameter ϕd_2 | Outlet pipe diameter ϕD | |
| 142 (1.4 l/s) | 75 | <input type="checkbox"/> |
| 142 (1.6 l/s) | 110 | <input type="checkbox"/> |
| 157 (2.7 l/s) | 75 | <input type="checkbox"/> |
| 157 (3.5 l/s) | 110 | <input type="checkbox"/> |
| 218 (5.0 l/s) | 110 | <input type="checkbox"/> |
| 218 (5.0 l/s) | 160 | <input type="checkbox"/> |

| Horizontal outlet | | |
|--------------------------------|-------------------------------|--------------------------|
| Gully body diameter ϕd_2 | Outlet pipe diameter ϕD | |
| 142 (1.4 l/s) | 75 | <input type="checkbox"/> |
| 142 (1.6 l/s) | 110 | <input type="checkbox"/> |
| 157 (2.6 l/s) | 75 | <input type="checkbox"/> |
| 157 (2.8 l/s) | 110 | <input type="checkbox"/> |
| 218 (4.4 l/s) | 110 | <input type="checkbox"/> |

ACO box channel
ACO customized box channel

Without gully (outlet pipe only)

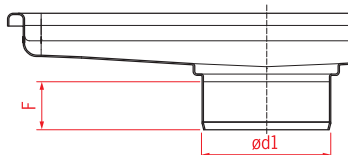

| Outlet diameter | |
|------------------|-------------------------------------|
| $\varnothing d1$ | |
| 75 | <input type="checkbox"/> |
| 110 | <input type="checkbox"/> |
| 125 | <input checked="" type="checkbox"/> |
| 142 | <input checked="" type="checkbox"/> |
| 200 | <input checked="" type="checkbox"/> |

| Outlet length | |
|---------------|-------------------------------------|
| F | |
| 36 | <input checked="" type="checkbox"/> |
| 58 | <input checked="" type="checkbox"/> |
| 150 | <input checked="" type="checkbox"/> |
| Custom | <input checked="" type="checkbox"/> |

Step 5 - Accessories

| Foul air trap (FAT) | |
|---------------------|-------------------------------------|
| With FAT | <input checked="" type="checkbox"/> |
| Without FAT | <input type="checkbox"/> |

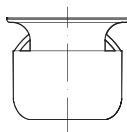

| Silt basket | |
|---------------------|-------------------------------------|
| With Silt basket | <input checked="" type="checkbox"/> |
| Without Silt basket | <input checked="" type="checkbox"/> |

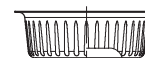

| Raising piece | |
|---------------------|-------------------------------------|
| Location flange (a) | <input checked="" type="checkbox"/> |
| Bonding flange (b) | <input checked="" type="checkbox"/> |
| Clamping flange (c) | <input checked="" type="checkbox"/> |

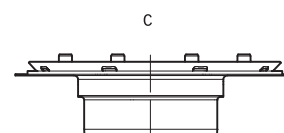
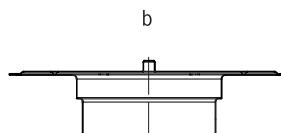
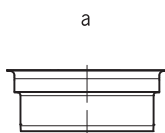

Step 6 - Delivery requirements

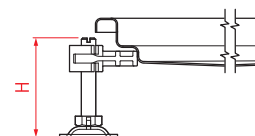
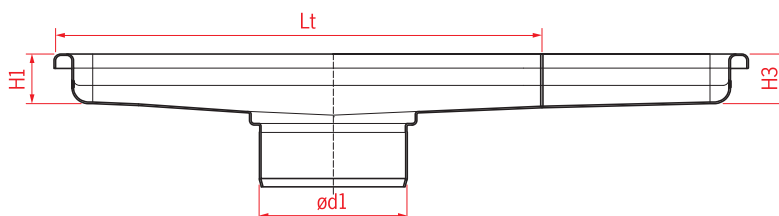

| Transport connection | | Connection type | |
|----------------------|-----------------|-------------------------------------|--------------------------|
| | | Welded on site | Rubber seal |
| Length L_t | 6000 (standard) | <input checked="" type="checkbox"/> | <input type="checkbox"/> |
| | 3000 | <input checked="" type="checkbox"/> | <input type="checkbox"/> |
| | 2000 | <input checked="" type="checkbox"/> | <input type="checkbox"/> |

| ACO EasyFix levelling feet H | |
|------------------------------|-------------------------------------|
| 80 (standard) | <input checked="" type="checkbox"/> |
| 110 | <input checked="" type="checkbox"/> |
| 170 | <input checked="" type="checkbox"/> |
| 200 | <input checked="" type="checkbox"/> |

ACO channel

Step 7 - Gratings



| | |
|-------------------------------------|-------------------------------------|
| ACO hygienic ladder grating | <input checked="" type="checkbox"/> |
| Slip resistant | <input type="checkbox"/> |
| Load class | <input type="checkbox"/> |
| R 50 (valid up to $W_o = 800$) | <input checked="" type="checkbox"/> |
| M 125 (valid up to $W_o = 500$) | <input checked="" type="checkbox"/> |
| N 250 (valid up to $W_o = 300$) | <input checked="" type="checkbox"/> |
| P 400 (custom) | <input checked="" type="checkbox"/> |

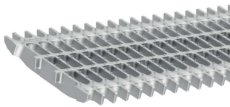

| | |
|---|-------------------------------------|
| ACO hygienic cast grating | <input checked="" type="checkbox"/> |
| Slip resistant | <input type="checkbox"/> |
| Load class | <input type="checkbox"/> |
| M 125 (max. $W_o = 300$) (valid up to $W_o = 300$) | <input checked="" type="checkbox"/> |



| | |
|---|--------------------------|
| ACO mesh grating | <input type="checkbox"/> |
| Slip resistant | <input type="checkbox"/> |
| Plain | <input type="checkbox"/> |
| Load class | <input type="checkbox"/> |
| L 15 (valid up to $W_o = 1000$) | <input type="checkbox"/> |
| R 50 (max. $W_o = 300$) (valid up to $W_o = 300$) | <input type="checkbox"/> |
| M 125 (max. $W_o = 300$) (valid up to $W_o = 300$) | <input type="checkbox"/> |

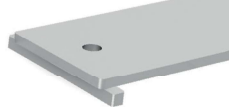

| | |
|-------------------------------------|--------------------------|
| ACO slot cover | <input type="checkbox"/> |
| Load class | <input type="checkbox"/> |
| R 50 (valid up to $W_o = 300$) | <input type="checkbox"/> |
| M 125 (valid up to $W_o = 300$) | <input type="checkbox"/> |

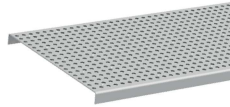

| | |
|------------------------------------|--------------------------|
| ACO perforated grating | <input type="checkbox"/> |
| Load class | <input type="checkbox"/> |
| L 15 (valid up to $W_o = 300$) | <input type="checkbox"/> |



| | |
|--|--------------------------|
| ACO multi-slot 5 grating | <input type="checkbox"/> |
| Load class | <input type="checkbox"/> |
| L 15 (valid up to $W_o = 300$) | <input type="checkbox"/> |
| R 50 (max. $W_o = 300$) (valid up to $W_o = 300$) | <input type="checkbox"/> |



| | |
|--|--------------------------|
| ACO heelsafe grating | <input type="checkbox"/> |
| Load class | <input type="checkbox"/> |
| L 15 (max. $W_o = 300$) (valid up to $W_o = 300$) | <input type="checkbox"/> |

Without gratings



| | |
|-----------------------------|-------------------------------------|
| Height of gratings E | <input type="checkbox"/> |
| 20 | <input checked="" type="checkbox"/> |
| 25 | <input checked="" type="checkbox"/> |
| 30 | <input checked="" type="checkbox"/> |
| 40 | <input checked="" type="checkbox"/> |

Step 8 - Protective covers

With protective covers
(For more information about protective covers, see page 230.)



Introduction

ACO slot channel portfolio

The ACO slot channel range covers channels for all common applications and all common floor types (concrete, tiles, resin or vinyl). Selecting a channel from the range is easy. The unique variability of the whole portfolio allows choosing the right channel according to all customers' needs.

Channel's length, depth and outlet position are just a few of the parameters which can be varied and, regardless of the variations specified, there is no impact on delivery lead times.

ACO slot channel ordering

The dimensions of the ACO slot channel can be easily specified in respect of project requirements. To specify the channel please use the Customization template (see page 109) which will help you to identify the information needed or contact our Sales/Technical department.

ACO slot channel customization

In addition all ACO slot channel can be designed with:

- Special outlet position
- Special depth
- Special slope
- Special slot channel width
- L-shape and T-shape layout
- Special side inlets

To request customised ACO slot channel, please contact our Sales/technical department.

ACO slot channel system overview

ACO slot channel - fixed height solution



ACO slot channel - telescopic solution



ACO slot channel - semi-standard

Product information

The dimensions of the ACO slot channel for concrete, tiles and resin floor can be easily specified in respect of project requirements.

- Tested and certified according to EN 1253
- Available in 1.4301 (304) or 1.4404 (316L) grades of stainless steel, pickled and passivated
- 1.5 mm material thickness
- ACO slot channel 8 or 20 mm
- Length – up to customer request
- Longitudinal slopes of the channel bottom 1-5 %
- Standardized widths
- Outlet position central or variable in longitudinal axis
- Adjustable EasyFix levelling feet
- Anchors for fixing in concrete
- Protective cover available.
See page 230 for more details

Order information

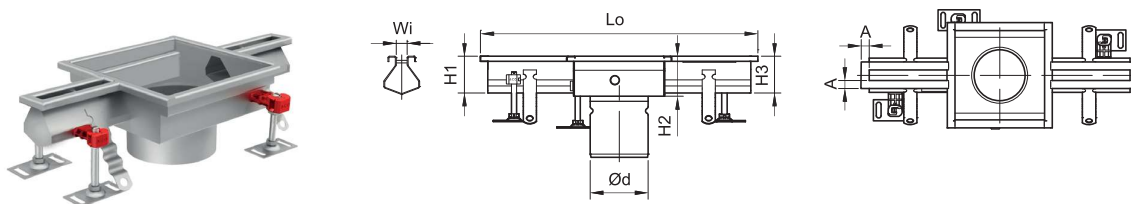

| External (overall) width Wi [mm] | Dimension of edge A [mm] | Length of channel Lo | Height at outlet of channel H2 | Height at end of channel H1 and H3 |
|-------------------------------------|-----------------------------|-------------------------|-----------------------------------|---------------------------------------|
| 20 | 15 | Variable * | 50-200 | 50-200 |
| 8 | folded | | 50-200 | 50-200 |

* The maximum transportable length of channel is 6 000 mm. Long channels over 6 000 mm are standardly divided in 6 m sections with transport joins.

ACO customized slot channel

Product information

The dimensions of the ACO customized slot channel for concrete, tiles and resin floor can be easily specified in respect of project requirements.

- Tested and certified according to EN 1253
- Available in 1.4301 (304) or 1.4404 (316L) grades of stainless steel, pickled and passivated
- 1.5 mm material thickness
- Slot of channel 8 or 20
- Length – up to customer request
- Longitudinal slopes of the channel bottom 1-5 %
- Outlet position central or variable in longitudinal axis
- Adjustable EasyFix levelling feet
- Anchors for fixing in concrete
- Protective covers available for gully tops. See page 230 for more details

Instructions

Please define channel dimensions by filling out required entry fields.

Step 1 - Material

Stainless steel grade 1.4301 (AISI 304)

Stainless steel grade 1.4404 (AISI 316L)

Step 2 - Edge profiles



Detail of the Edge profile

Standard

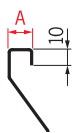

| A | 15 | 25 |
|--------------------|--------------------------|--------------------------|
| Rubber edge infill | <input type="checkbox"/> | <input type="checkbox"/> |
| Steel edge infill | <input type="checkbox"/> | <input type="checkbox"/> |
| No edge infill | <input type="checkbox"/> | <input type="checkbox"/> |

Folded



Extended

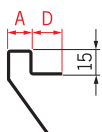

| A | 15 | 25 |
|--------------------|--------------------------|--------------------------|
| Rubber edge infill | <input type="checkbox"/> | <input type="checkbox"/> |
| Steel edge infill | <input type="checkbox"/> | <input type="checkbox"/> |
| No edge infill | <input type="checkbox"/> | <input type="checkbox"/> |

Folded with flange

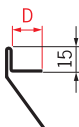

| D | 50 | Custom |
|---|--------------------------|--------------------------|
| | <input type="checkbox"/> | <input type="checkbox"/> |

| D | 50 | Custom |
|---|--------------------------|--------------------------|
| | <input type="checkbox"/> | <input type="checkbox"/> |

L profile

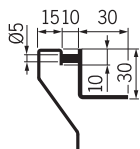

Step 3 - Channel dimensions

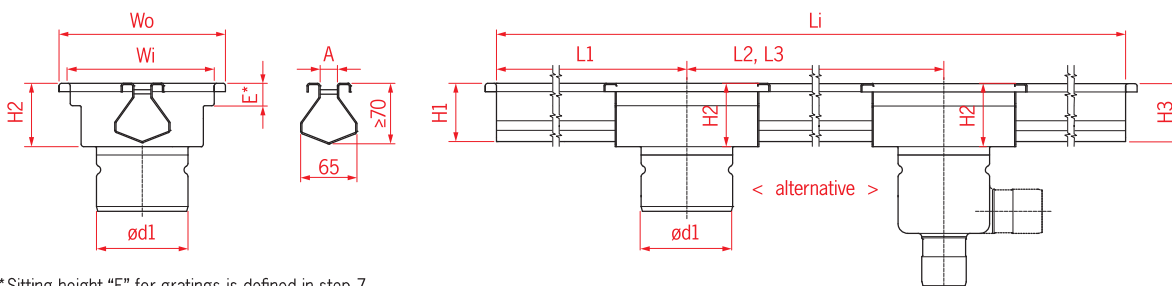

*Sitting height "E" for gratings is defined in step 7

| Gully top dimension Wo | Channel outlet d1 |
|------------------------|-------------------|
| 200 x 200 | 75 |
| 200 x 200 | 110 |
| 200 x 200 | 125 |
| 250 x 250 | 142 |
| 300 x 300 | 200 |
| Customized width | |

| Channel bottom height | |
|---|----|
| | H2 |
| Slope | |
| No | |
| Yes - slope 1% | |
| Yes - height defined (If you require values below 70 mm, please contact technical support) | H1 |
| | H3 |

| Channel lengths | |
|-----------------|--|
| Li | |
| L1 | |
| L2 | |
| L3 | |

| Slot dimension A |
|------------------|
| 8 |
| 20 |

ACO channel

Step 4 - Gully

Welded gully

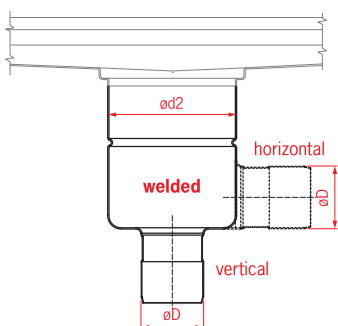

Telescopic gully

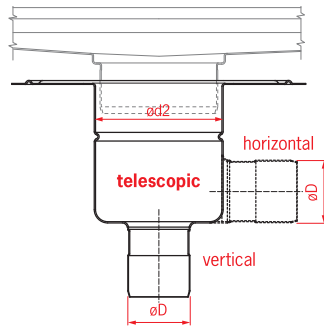

Location flange
(For telescopic gully only)

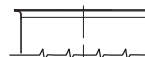

Bonding flange
(For telescopic gully only)



Clamping flange
(For telescopic gully only)



| Vertical outlet | |
|-------------------------|-------------------------|
| Gully body diameter ød2 | Outlet pipe diameter øD |
| 142 (1.4 l/s) | 75 |
| 142 (1.6 l/s) | 110 |
| 157 (2.7 l/s) | 75 |
| 157 (3.5 l/s) | 110 |
| 218 (5.0 l/s) | 110 |
| 218 (5.0 l/s) | 160 |

| Horizontal outlet | |
|-------------------------|-------------------------|
| Gully body diameter ød2 | Outlet pipe diameter øD |
| 142 (1.4 l/s) | 75 |
| 142 (1.6 l/s) | 110 |
| 157 (2.6 l/s) | 75 |
| 157 (2.8 l/s) | 110 |
| 218 (4.4 l/s) | 110 |

Without gully (outlet pipe only)

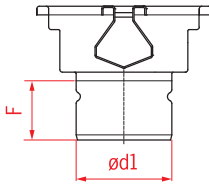

| Channel outlet | | |
|-----------------|-----|--------------------------|
| Outlet diameter | | |
| Wo | ød1 | <input type="checkbox"/> |
| 200 x 200 | 75 | <input type="checkbox"/> |
| 200 x 200 | 110 | <input type="checkbox"/> |
| 200 x 200 | 125 | <input type="checkbox"/> |
| 250 x 250 | 142 | <input type="checkbox"/> |
| 300 x 300 | 200 | <input type="checkbox"/> |

| Outlet length | | |
|---------------|--|--------------------------|
| F | | |
| 36 | | <input type="checkbox"/> |
| 58 | | <input type="checkbox"/> |
| 150 | | <input type="checkbox"/> |
| Custom | | <input type="checkbox"/> |

Step 5 - Accessories

| Foul air trap (FAT) | | |
|---------------------|--|--------------------------|
| With FAT | | <input type="checkbox"/> |
| Without FAT | | <input type="checkbox"/> |

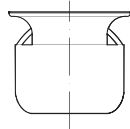

| Silt basket | | |
|---------------------|--|--------------------------|
| With Silt basket | | <input type="checkbox"/> |
| Without Silt basket | | <input type="checkbox"/> |

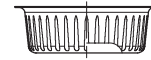

| Raising piece | | |
|---------------------|--|--------------------------|
| Location flange (a) | | <input type="checkbox"/> |
| Bonding flange (b) | | <input type="checkbox"/> |
| Clamping flange (c) | | <input type="checkbox"/> |

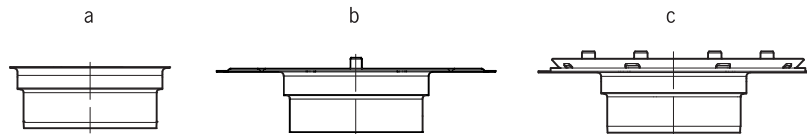

Step 6 - Delivery requirements

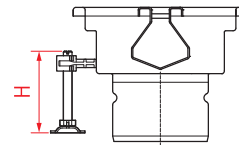
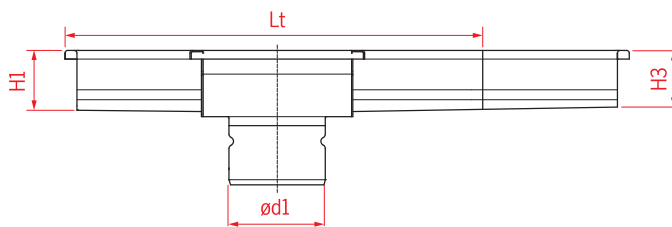

| Transport connection Lt | | |
|-------------------------|--|--------------------------|
| 6000 (standard) | | <input type="checkbox"/> |
| 3000 | | <input type="checkbox"/> |
| 2000 | | <input type="checkbox"/> |

| ACO EasyFix levelling feet H | | |
|------------------------------|--|--------------------------|
| 80 (standard) | | <input type="checkbox"/> |
| 110 | | <input type="checkbox"/> |
| 170 | | <input type="checkbox"/> |
| 200 | | <input type="checkbox"/> |

Step 7 - Gratings



| | |
|-------------------------------------|--------------------------|
| ACO hygienic ladder grating | <input type="checkbox"/> |
| Slip resistant | <input type="checkbox"/> |
| Load class | |
| R 50 (valid up to $W_o = 300$) | <input type="checkbox"/> |
| M 125 (valid up to $W_o = 300$) | <input type="checkbox"/> |
| C 250 (valid up to $W_o = 300$) | <input type="checkbox"/> |



| | |
|-------------------------------------|--------------------------|
| ACO hygienic cast grating | <input type="checkbox"/> |
| Slip resistant | <input type="checkbox"/> |
| Load class | |
| M 125 (valid up to $W_o = 300$) | <input type="checkbox"/> |

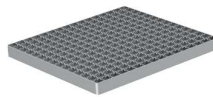

| | |
|------------------------------------|--------------------------|
| ACO mesh grating | <input type="checkbox"/> |
| Slip resistant | <input type="checkbox"/> |
| Plain | <input type="checkbox"/> |
| Load class | |
| L 15 (valid up to $W_o = 300$) | <input type="checkbox"/> |
| R 50 (valid up to $W_o = 300$) | <input type="checkbox"/> |



| | |
|-------------------------------------|--------------------------|
| ACO slot cover | <input type="checkbox"/> |
| Load class | |
| M 125 (valid up to $W_o = 300$) | <input type="checkbox"/> |

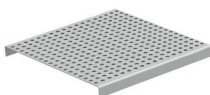

| | |
|------------------------------------|--------------------------|
| ACO perforated grating | <input type="checkbox"/> |
| Load class | |
| L 15 (valid up to $W_o = 300$) | <input type="checkbox"/> |
| R 50 (valid up to $W_o = 300$) | <input type="checkbox"/> |



| | |
|------------------------------------|--------------------------|
| ACO multi-slot 5 grating | <input type="checkbox"/> |
| Load class | |
| L 15 (valid up to $W_o = 300$) | <input type="checkbox"/> |
| R 50 (valid up to $W_o = 300$) | <input type="checkbox"/> |



| | |
|------------------------------------|--------------------------|
| ACO heelsafe grating | <input type="checkbox"/> |
| Load class | |
| L 15 (valid up to $W_o = 300$) | <input type="checkbox"/> |

Without grating



| | |
|-----------------------------|--------------------------|
| Height of gratings E | |
| 20 | <input type="checkbox"/> |
| 25 | <input type="checkbox"/> |
| 30 | <input type="checkbox"/> |
| 40 | <input type="checkbox"/> |

Step 8 - Protective covers

With protective covers (Only available for outlet units)
 For more information about protective covers, see page 230.)



Your specification/shape of the channel, outlet position

A large grid for drawing specifications, consisting of 30 columns and 30 rows of small squares. The grid is intended for users to draw or specify the shape and outlet position of a channel.

Introduction

ACO modular channel portfolio

The ACO modular channel range includes channels for all common applications and all common floor types (concrete, tiles, resin or vinyl). Selecting a channel from the range is easy. The unique variability of the whole portfolio makes it easy to choose the right channel according to a specific customer's needs. Channel's length, depth and outlet position

are just a few of the parameters which can be varied and, regardless of the variations specified, there is no impact on delivery lead times.

ACO modular channel ordering

The dimensions of the ACO modular channel can be easily specified in respect of project requirements.

ACO modular channel customization

In addition, all ACO modular channels can be designed to a special length.

To request customised ACO modular channel, please contact our Sales/ Technical department.

ACO modular sloped channel connection

Sloped channels are provided with rubber seal at the deep end of the channel only.

If your design plan includes channels connection at shallow ends, make sure that appropriate amount of rubber seals is included in your order.

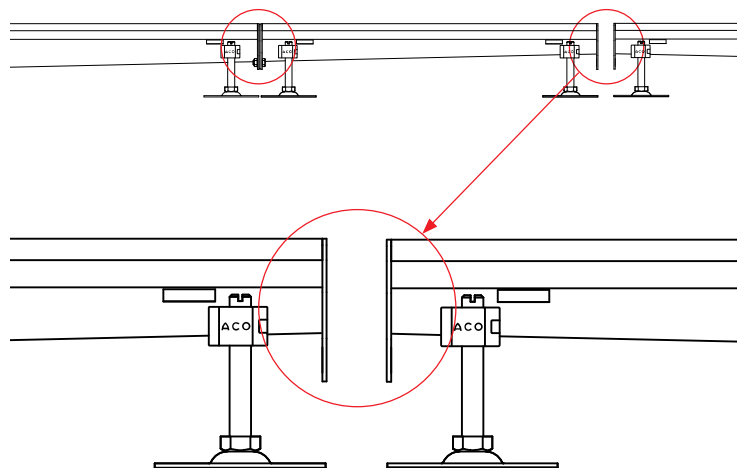

ACO modular channel system overview



ACO modular box channel 125



ACO modular box channel 200



ACO modular slot channel 20



**ACO gully
with accessories**

ACO channel

ACO modular box channel system overview

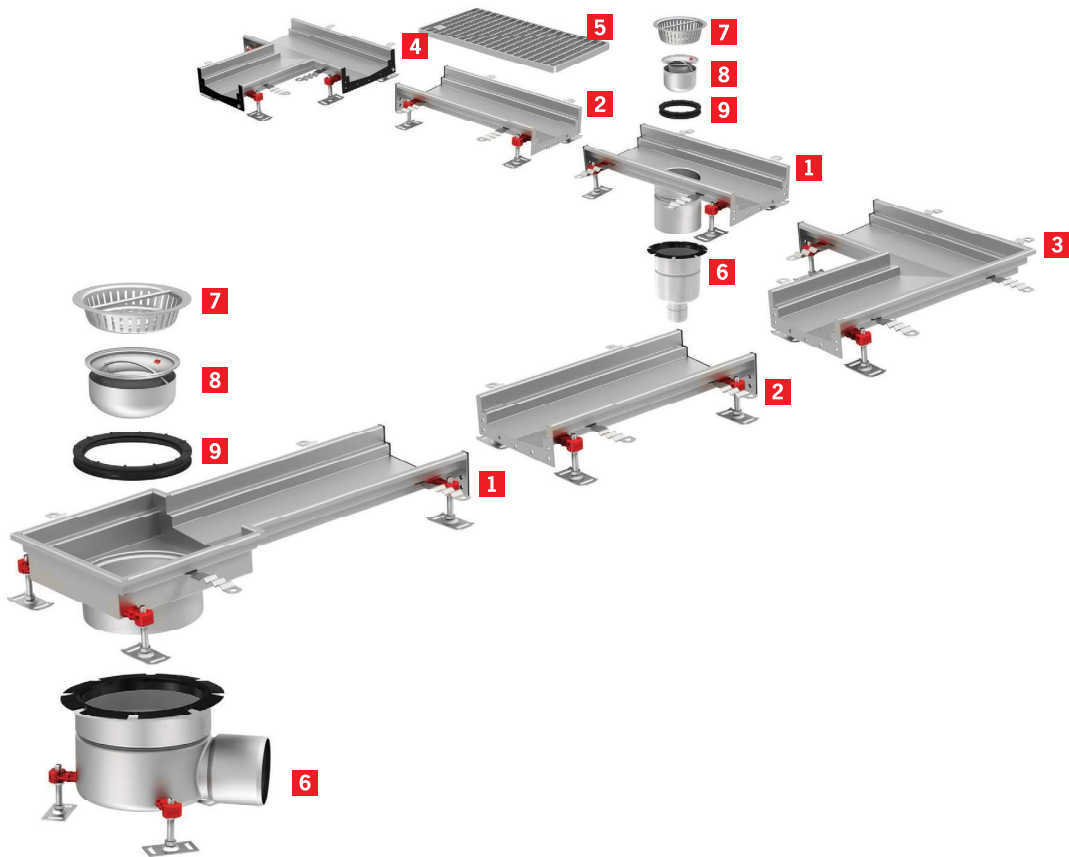

ACO modular slot channel system overview

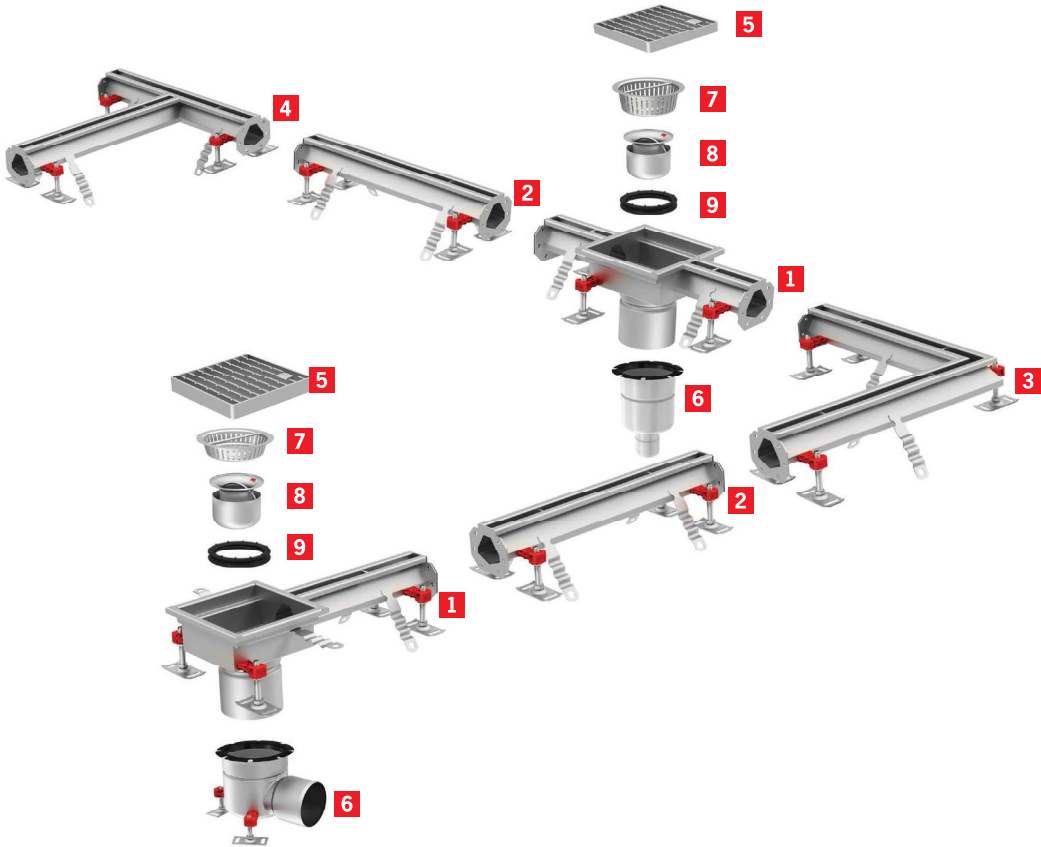

- 1 Outlet unit
- 2 Level invert and sloping invert channel
- 3 Corner unit
- 4 Branch unit
- 5 Grating
- 6 Gully
- 7 Silt basket
- 8 Foul air trap
- 9 Foul air trap support

ACO modular box channel 125 - standard articles

Product information

Modular concept allows specification of standard channel units to surround machinery and fit within existing tiling patterns.

Vee-bottomed (V) profiled channel for enhanced flow efficiency at low flow rates and for improved self cleaning performance.

- Fully compliant to EN 1253
- Fully tested and classified to EN 1433
- Available in 1.4301 (304) or 1.4404 (316L) grades of stainless steel
- Fully pickled and passivated
- Easy and secure telescopic connection with gully
- Cut on demand items available to minimize works on site
- Wide range of gratings for load class up to C 250 (EN 1433)

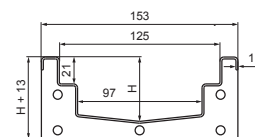

Level invert channel

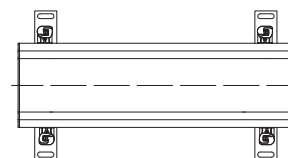
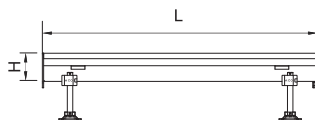

ACO channel

| L [mm] | Dimensions | | Item number | |
|--------|------------|--------|---------------|---------------|
| | | H [mm] | 1.4301 | 1.4404 |
| 500 | | 50 | 105119 | 407211 |
| | | 65 | 105120 | 407212 |
| | | 80 | 105121 | 407213 |
| | | 95 | 105122 | 407214 |
| | | 110 | 105123 | 407215 |
| | | 125 | 105124 | 407216 |
| 1000 | | 50 | 105127 | 407217 |
| | | 65 | 105128 | 407218 |
| | | 80 | 105129 | 407219 |
| | | 95 | 105130 | 407220 |
| | | 110 | 105131 | 407221 |
| | | 125 | 105132 | 407222 |
| 2000 | | 50 | 105135 | 407223 |
| | | 65 | 105136 | 407224 |
| | | 80 | 105137 | 407225 |
| | | 95 | 105138 | 407226 |
| | | 110 | 105139 | 407227 |
| | | 125 | 105140 | 407228 |
| 3000 | | 50 | 105143 | 407229 |
| | | 65 | 105144 | 407230 |
| | | 80 | 105145 | 407231 |
| | | 95 | 105146 | 407232 |
| | | 110 | 105147 | 407233 |
| | | 125 | 105148 | 407234 |

Note: Items are equipped with seal and connecting material on one side.

Sloping invert channel

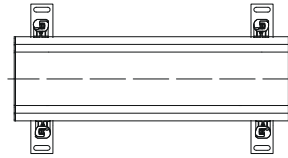
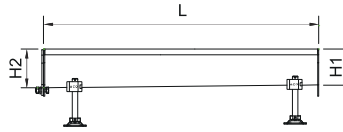

| L [mm] | Dimensions | | Item number | |
|--------|------------|---------|---------------|---------------|
| | H1 [mm] | H2 [mm] | 1.4301 | 1.4404 |
| 500 | 50 | 65 | 105151 | 407235 |
| | 65 | 80 | 105152 | 407236 |
| 1000 | 50 | 65 | 105155 | 407237 |
| | 65 | 80 | 105156 | 407238 |
| | 80 | 95 | 105157 | 407239 |
| | 95 | 110 | 105158 | 407240 |
| 2000 | 50 | 65 | 105161 | 407241 |
| | 65 | 80 | 105162 | 407242 |
| | 80 | 95 | 105163 | 407243 |
| | 95 | 110 | 105164 | 407244 |
| | 110 | 125 | 105165 | 407245 |
| 3000 | 50 | 65 | 105168 | 407246 |
| | 65 | 80 | 105169 | 407247 |
| | 80 | 95 | 105170 | 407248 |
| | 95 | 110 | 105171 | 407249 |
| | 110 | 125 | 105172 | 407250 |
| 6000 | 50 | 80 | 408821 | 408824 |
| | 65 | 95 | 408822 | 408825 |
| | 95 | 125 | 408823 | 408826 |

Note: Items are equipped with seal and connecting material on deeper side only. See page 114 for more details.

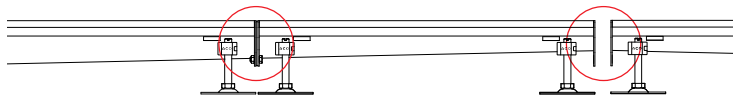

Corner unit

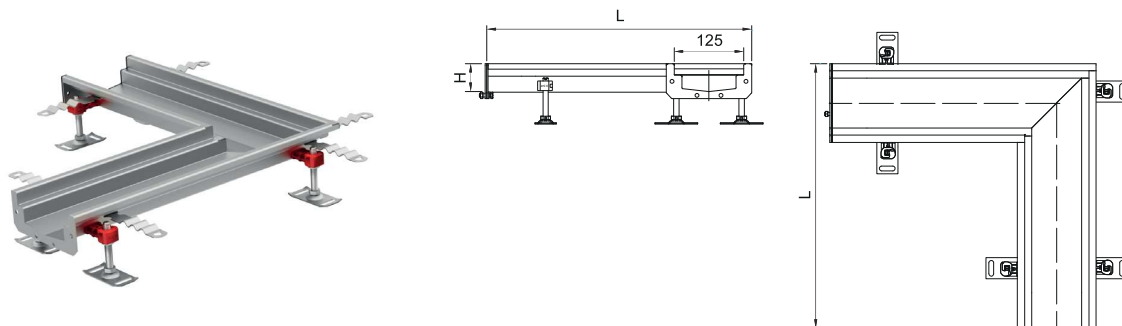

| Dimensions | | Item number | |
|------------|--------|---------------|---------------|
| L [mm] | H [mm] | 1.4301 | 1.4404 |
| 515 | 50 | 409812 | 409818 |
| | 65 | 409813 | 409819 |
| | 80 | 409814 | 409820 |
| | 95 | 409815 | 409821 |
| | 110 | 409816 | 409822 |
| | 125 | 409817 | 409823 |

Note: Items are equipped with seal and connecting material on one side.

Branch unit

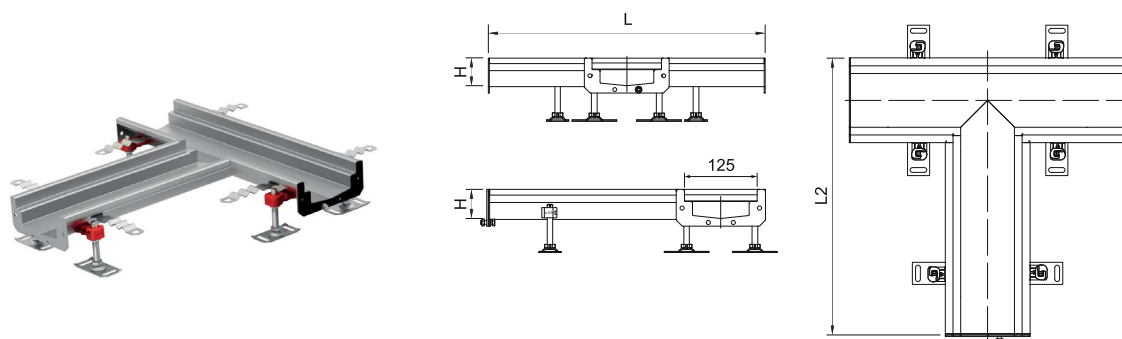

| Dimensions | | | Item number | |
|------------|---------|--------|---------------|---------------|
| L1 [mm] | L2 [mm] | H [mm] | 1.4301 | 1.4404 |
| 500 | 515 | 50 | 409824 | 409830 |
| | | 65 | 409825 | 409831 |
| | | 80 | 409826 | 409832 |
| | | 95 | 409827 | 409833 |
| | | 110 | 409828 | 409834 |
| | | 125 | 409829 | 409835 |

Note: Items are equipped with seal and connecting material on one side.

End outlet

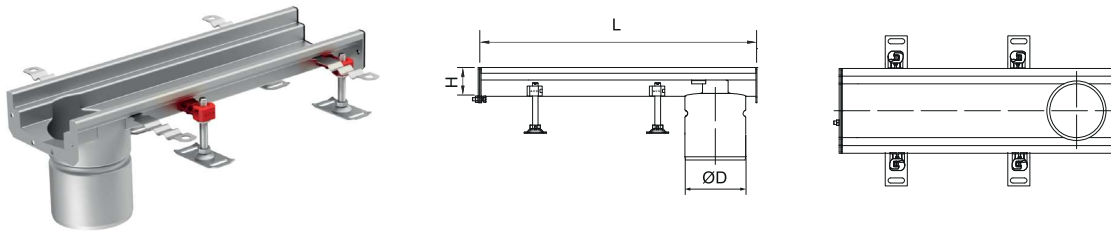

| Dimensions | | Gully | Outlet diameter øD [mm] | Item number | | | |
|------------|--------|------------------------|----------------------------|---------------|---------------|---------------|---------------|
| L [mm] | H [mm] | | | 1.4301 | 1.4404 | | |
| 500 | 50 | ACO gully EG150 | 110 | 105175 | 407251 | | |
| | 65 | | | 105176 | 407252 | | |
| | 80 | | | 105177 | 407253 | | |
| | 95 | | | 105178 | 407254 | | |
| | 110 | | | 105179 | 407255 | | |
| | 125 | | | 105180 | 407256 | | |
| 1000 | 50 | | | | | 105183 | 407257 |
| | 65 | | | | | 105184 | 407258 |
| | 80 | | | | | 105185 | 407259 |
| | 95 | | | | | 105186 | 407260 |
| | 110 | | | | | 105187 | 407261 |
| | 125 | | | | | 105188 | 407262 |
| 500 | 50 | ACO hygienic gully 142 | 125 | 415946 | 415991 | | |
| | 65 | | | 415947 | 415992 | | |
| | 80 | | | 415948 | 415993 | | |
| | 95 | | | 415949 | 415994 | | |
| | 110 | | | 415950 | 415995 | | |
| | 125 | | | 415951 | 415996 | | |
| 1000 | 50 | | | | | 415952 | 415997 |
| | 65 | | | | | 415953 | 415998 |
| | 80 | | | | | 415954 | 415999 |
| | 95 | | | | | 415955 | 416000 |
| | 110 | | | | | 415956 | 416001 |
| | 125 | | | | | 415957 | 416002 |
| 500 | 50 | ACO hygienic gully 157 | 142 | 409732 | 409733 | | |
| | 65 | | | 409736 | 409737 | | |
| | 80 | | | 409740 | 409741 | | |
| | 95 | | | 409744 | 409745 | | |
| | 110 | | | 409724 | 409725 | | |
| | 125 | | | 409728 | 409729 | | |
| 1000 | 50 | | | | | 409708 | 409709 |
| | 65 | | | | | 409712 | 409713 |
| | 80 | | | | | 409716 | 409717 |
| | 95 | | | | | 409720 | 409721 |
| | 110 | | | | | 409700 | 409701 |
| | 125 | | | | | 409704 | 409705 |

Note: Items are equipped with seal and connecting material on one side.

Centre outlet

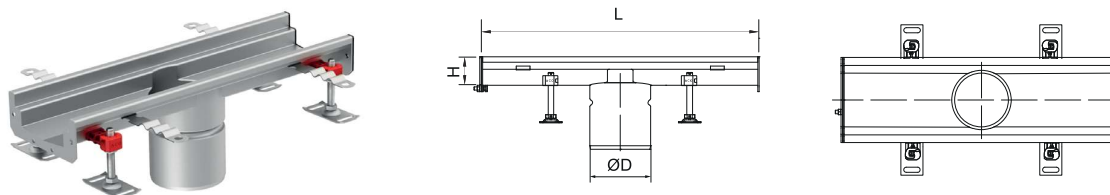

| Dimensions | | Gully | Outlet diameter øD [mm] | Item number | | | |
|------------|--------|------------------------|----------------------------|------------------------|---------------|---------------|---------------|
| L [mm] | H [mm] | | | 1.4301 | 1.4404 | | |
| 500 | 50 | ACO gully EG150 | 110 | 105191 | 407263 | | |
| | 65 | | | 105192 | 407264 | | |
| | 80 | | | 105193 | 407265 | | |
| | 95 | | | 105194 | 407266 | | |
| | 110 | | | 105195 | 407267 | | |
| | 125 | | | 105196 | 407268 | | |
| 1000 | 50 | | | 105199 | 407269 | | |
| | 65 | | | 105200 | 407270 | | |
| | 80 | | | 105201 | 407271 | | |
| | 95 | | | 105202 | 407272 | | |
| | 110 | | | 105203 | 407273 | | |
| | 125 | | | 105204 | 407274 | | |
| 500 | 50 | | | ACO hygienic gully 142 | 125 | 415958 | 416003 |
| | 65 | | | | | 415959 | 416004 |
| | 80 | | | | | 415960 | 416005 |
| | 95 | | | | | 415961 | 416006 |
| | 110 | | | | | 415962 | 416007 |
| | 125 | | | | | 415963 | 416008 |
| 1000 | 50 | 415964 | 416009 | | | | |
| | 65 | 415965 | 416010 | | | | |
| | 80 | 415966 | 416011 | | | | |
| | 95 | 415967 | 416012 | | | | |
| | 110 | 415968 | 416013 | | | | |
| | 125 | 415969 | 416014 | | | | |
| 500 | 50 | ACO hygienic gully 157 | 142 | | | 409734 | 409735 |
| | 65 | | | | | 409738 | 409739 |
| | 80 | | | | | 409742 | 409743 |
| | 95 | | | | | 409746 | 409747 |
| | 110 | | | | | 409726 | 409727 |
| | 125 | | | | | 409730 | 409731 |
| 1000 | 50 | | | 409710 | 409711 | | |
| | 65 | | | 409714 | 409715 | | |
| | 80 | | | 409718 | 409719 | | |
| | 95 | | | 409722 | 409723 | | |
| | 110 | | | 409702 | 409703 | | |
| | 125 | | | 409706 | 409707 | | |

Note: Items are equipped with seal and connecting material on one side.

End plate

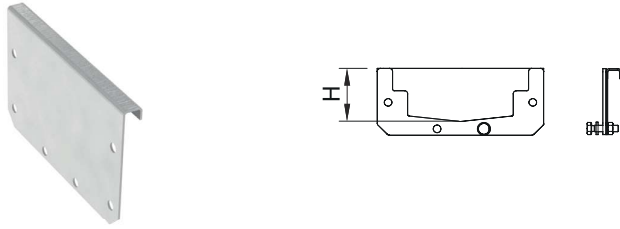

| Dimensions | Item number | |
|------------|---------------|---------------|
| | 1.4301 | 1.4404 |
| H [mm] | | |
| 50 | 105100 | 407196 |
| 65 | 105101 | 407197 |
| 80 | 105102 | 407198 |
| 95 | 105103 | 407199 |
| 110 | 105104 | 407200 |
| 125 | 105105 | 407201 |

Note: Items are equipped with seal and connecting material.

End plate with 50 mm outlet

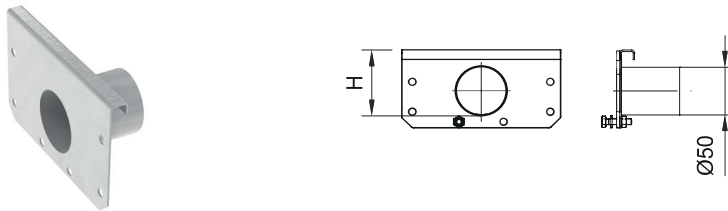

| Dimensions | Item number | |
|------------|---------------|---------------|
| | 1.4301 | 1.4404 |
| H [mm] | | |
| 65 | 409114 | 409119 |
| 80 | 409115 | 409120 |
| 95 | 409116 | 409121 |
| 110 | 409117 | 409122 |
| 125 | 409118 | 409123 |

Note: Items are equipped with seal and connecting material.

Seal rubber

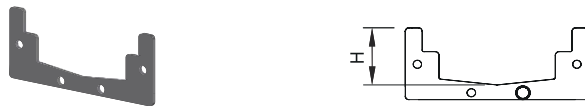

| Dimensions | Item number |
|------------|---------------|
| | NBR |
| H [mm] | |
| 50 | 413587 |
| 65 | 413588 |
| 80 | 413589 |
| 95 | 413590 |
| 110 | 413591 |
| 125 | 413592 |

Note: Items include seal and connecting material.

Gratings for ACO modular box channel 125

Product information

- Fully tested and classified to EN 1433
- Available in 1.4301 (304) or 1.4404 (316L) grades of stainless steel
- Special length 375 mm for branches and corner units
- Slip resistant gratings available for added user safety
- Load classes A 15, B 125 and C 250

ACO mesh grating

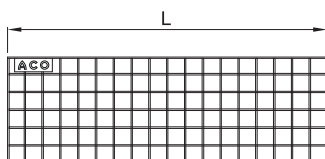

ACO channel

| Length L [mm] | Load class | Slip resistant | Material | Item number | |
|------------------|------------|----------------|----------|---------------|---------------|
| 375 | A 15 | No | 1.4301 | 414132 | |
| | | | 1.4404 | 414182 | |
| | C 250 | Yes | 1.4301 | 414130 | |
| | | | 1.4404 | 414180 | |
| | | C 250 | No | 1.4301 | 414133 |
| | | | | 1.4404 | 414183 |
| 500 | A 15 | Yes | 1.4301 | 414131 | |
| | | | 1.4404 | 414181 | |
| | C 250 | No | 1.4301 | 21720 | |
| | | | 1.4404 | 21725 | |
| | | C 250 | Yes | 1.4301 | 21710 |
| | | | | 1.4404 | 21715 |
| 1000 | A 15 | No | 1.4301 | 21920 | |
| | | | 1.4404 | 21925 | |
| | C 250 | Yes | 1.4301 | 21910 | |
| | | | 1.4404 | 21915 | |
| | | A 15 | No | 1.4301 | 21620 |
| | | | | 1.4404 | 21625 |
| | C 250 | Yes | 1.4301 | 21610 | |
| | | | 1.4404 | 21615 | |
| | C 250 | No | 1.4301 | 21820 | |
| | | | 1.4404 | 21825 | |
| | C 250 | Yes | 1.4301 | 21810 | |
| | | | 1.4404 | 21815 | |

ACO ladder grating

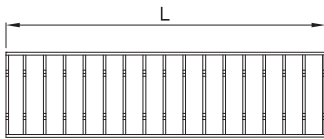

| Length L [mm] | Load class | Slip resistant | Material | Item number |
|------------------|------------|----------------|----------|---------------|
| 375 | C 250 | Yes | 1.4301 | 414134 |
| | | | 1.4404 | 414184 |
| 500 | C 250 | Yes | 1.4301 | 21740 |
| | | | 1.4404 | 21745 |
| 1000 | C 250 | Yes | 1.4301 | 21741 |
| | | | 1.4404 | 21746 |

ACO heelsafe grating

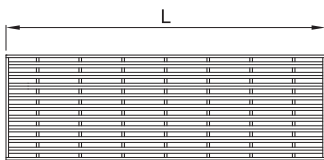

| Length L [mm] | Load class | Slip resistant | Material | Item number |
|------------------|------------|----------------|----------|---------------|
| 375 | B 125 | No | 1.4301 | 414135 |
| | | | 1.4404 | 414185 |
| 500 | B 125 | No | 1.4301 | 96819 |
| | | | 1.4404 | 401238 |
| 1000 | B 125 | No | 1.4301 | 96818 |
| | | | 1.4404 | 401237 |

ACO perforated grating

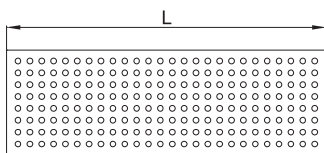

| Length L [mm] | Load class | Slip resistant | Material | Item number |
|------------------|------------|----------------|----------|---------------|
| 375 | A 15 | No | 1.4301 | 414136 |
| | | | 1.4404 | 414186 |
| | B 125 | No | 1.4301 | 414137 |
| | | | 1.4404 | 414187 |
| 500 | A 15 | No | 1.4301 | 21760 |
| | | | 1.4404 | 21765 |
| | B 125 | No | 1.4301 | 21960 |
| | | | 1.4404 | 21965 |
| 1000 | A 15 | No | 1.4301 | 21660 |
| | | | 1.4404 | 21665 |
| | B 125 | No | 1.4301 | 21860 |
| | | | 1.4404 | 21865 |

ACO quadrato grating

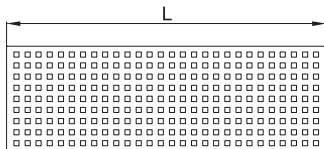

| Length L [mm] | Load class | Slip resistant | With lock | Material | Item number |
|------------------|------------|----------------|-----------|----------|---------------|
| 375 | A 15 | No | No | 1.4301 | 414138 |
| | | | | 1.4404 | 414188 |
| 500 | A 15 | No | No | 1.4301 | 105530 |
| | | | | 1.4404 | 413999 |
| | | | Yes | 1.4301 | 105528 |
| | | | | 1.4404 | 407925 |
| 1000 | A 15 | No | No | 1.4301 | 105529 |
| | | | | 1.4404 | 413998 |
| | | | Yes | 1.4301 | 105527 |
| | | | | 1.4404 | 407924 |

ACO plastic grating

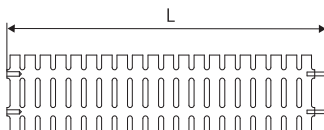

| Length L [mm] | Load class | Slip resistant | Material | Item number |
|------------------|------------|----------------|----------|--------------|
| 500 | A 15 | No | - | 21790 |
| 1000 | A 15 | No | - | 21690 |

ACO multi-slot 5 grating

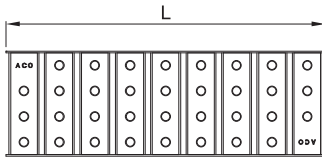

| Length L [mm] | Load class | Slip resistant | Material | Item number |
|------------------|------------|----------------|----------|---------------|
| 375 | A 15 | Yes | 1.4301 | 414139 |
| | | | 1.4404 | 414189 |
| 500 | A 15 | Yes | 1.4301 | 409290 |
| | | | 1.4404 | 409291 |
| | B 125 | Yes | 1.4301 | 409294 |
| | | | 1.4404 | 409295 |
| 1 000 | A 15 | Yes | 1.4301 | 409286 |
| | | | 1.4404 | 409287 |
| | B 125 | Yes | 1.4301 | 409236 |
| | | | 1.4404 | 409237 |

ACO multi-slot 8 grating

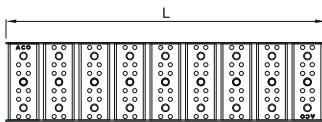

| Length L [mm] | Load class | Slip resistant | Material | Item number |
|------------------|------------|----------------|----------|---------------|
| 500 | A 15 | Yes | 1.4301 | 415739 |
| | | | 1.4404 | 415740 |
| | B 125 | Yes | 1.4301 | 415747 |
| | | | 1.4404 | 415748 |
| | C 250 | Yes | 1.4301 | 415753 |
| | | | 1.4404 | 415754 |
| 1 000 | A 15 | Yes | 1.4301 | 415735 |
| | | | 1.4404 | 415736 |
| | B 125 | Yes | 1.4301 | 415743 |
| | | | 1.4404 | 415744 |
| | C 250 | Yes | 1.4301 | 415751 |
| | | | 1.4404 | 415752 |

Accessories for ACO modular box channel 125

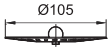
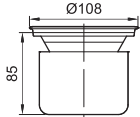
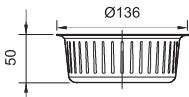
| | Description | Used with | Material | Item number |
|---|--|--|----------|---------------|
|  | Sieve ■ Stainless steel | ■ ACO modular box channel 125 with outlet 110 mm | 1.4301 | 97235 |
| | | | 1.4404 | 97285 |
|  | Foul air trap ■ Stainless steel ■ Water seal 50 mm | ■ ACO modular box channel 125 with outlet 110 mm | 1.4301 | 97217 |
| | | | 1.4404 | 97267 |
|  | Silt basket ■ Stainless steel ■ 0.5 litre capacity | ■ ACO modular box channel 125 with outlet 125 and 142 mm | 1.4301 | 414339 |
| | | | 1.4404 | 414340 |

ACO channel

ACO modular box channel 200 - standard articles

Product information

Modular concept allows specification of standard channel units to surround machinery and fit within existing tiling patterns.

- Fully compliant to EN 1253
- Fully tested and classified to EN 1433
- Available in 1.4301 (304) or 1.4404 (316L) grades of stainless steel
- Fully pickled and passivated
- Easy and secure telescopic connection with gully
- Cut on demand items available to minimize works on site
- Wide range of gratings for load class up to C 250 (EN 1433)

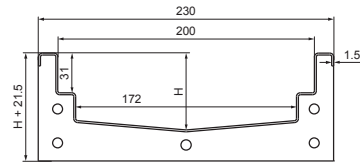

Level invert channel

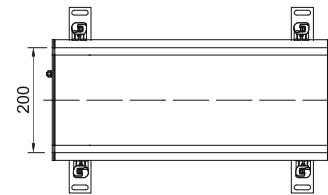

| L [mm] | Dimensions | | Item number | |
|--------|------------|--------|---------------|---------------|
| | | H [mm] | 1.4301 | 1.4404 |
| 500 | | 60 | 409072 | 409050 |
| | | 70 | 409047 | 409051 |
| | | 80 | 409048 | 409052 |
| | | 100 | 409049 | 409053 |
| 1000 | | 60 | 401859 | 401860 |
| | | 70 | 409054 | 409057 |
| | | 80 | 409055 | 409058 |
| | | 100 | 409056 | 409059 |
| 2000 | | 60 | 401875 | 401876 |
| | | 70 | 409060 | 409063 |
| | | 80 | 409061 | 409064 |
| | | 100 | 409062 | 409065 |
| 3000 | | 60 | 401895 | 401896 |
| | | 70 | 409066 | 409069 |
| | | 80 | 409067 | 409070 |
| | | 100 | 409068 | 409071 |

Note: Items are equipped with seal and connecting material on one side.

Sloping invert channel

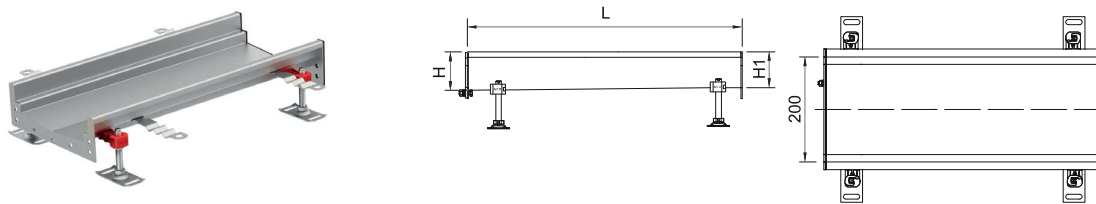

| L [mm] | Dimensions | | Item number | |
|--------|------------|---------|---------------|---------------|
| | H1 [mm] | H2 [mm] | 1.4301 | 1.4404 |
| 500 | 55 | 60 | 401855 | 401856 |
| 1000 | 60 | 70 | 401871 | 401872 |
| | 70 | 80 | 402464 | 402465 |
| | 80 | 90 | 402466 | 402467 |
| | 90 | 100 | 402468 | 402469 |
| | 100 | 110 | 402470 | 402471 |
| 2000 | 60 | 70 | 401887 | 401888 |
| | 70 | 80 | 402472 | 402473 |
| | 80 | 90 | 402474 | 402475 |
| | 90 | 100 | 402476 | 402477 |
| | 100 | 110 | 402478 | 402479 |
| 3000 | 110 | 120 | 402480 | 402481 |
| | 60 | 80 | 402482 | 402483 |
| | 80 | 100 | 402484 | 402485 |
| | 100 | 120 | 402486 | 402487 |
| 6000 | 120 | 140 | 402488 | 402489 |
| | 60 | 100 | 408827 | 408829 |
| | 100 | 140 | 408828 | 408830 |

Note: Items are equipped with seal and connecting material on deeper side only. See page 114 for more details.



Corner unit

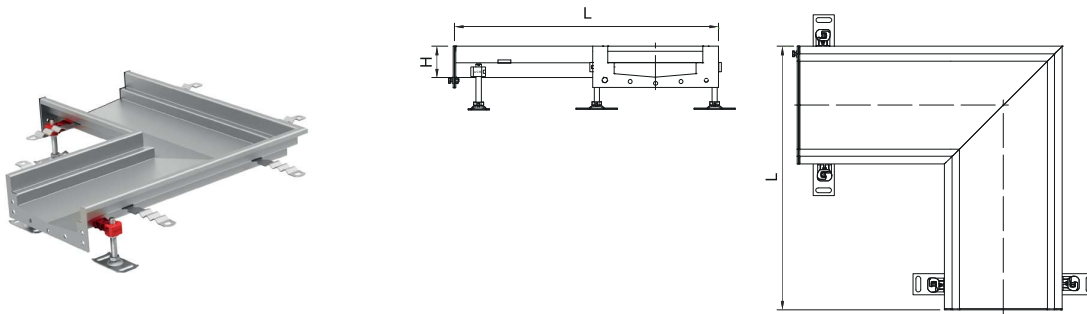

| Dimensions | | Item number | |
|------------|--------|---------------|---------------|
| L [mm] | H [mm] | 1.4301 | 1.4404 |
| 515 | 60 | 401921 | 401922 |
| | 80 | 402490 | 402491 |
| | 100 | 402492 | 402493 |

Note: Items are equipped with seal and connecting material on one side.

Branch unit

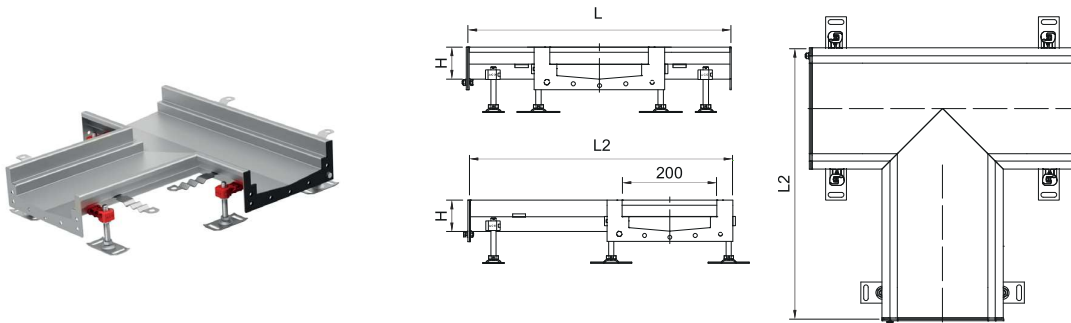

| Dimensions | | | Item number | |
|------------|---------|---------|---------------|---------------|
| L [mm] | H1 [mm] | H2 [mm] | 1.4301 | 1.4404 |
| 500 | 515 | 60 | 401933 | 401934 |
| | | 80 | 402494 | 402495 |
| | | 100 | 402496 | 402497 |

Note: Items are equipped with seal and connecting material on one side.

End outlet

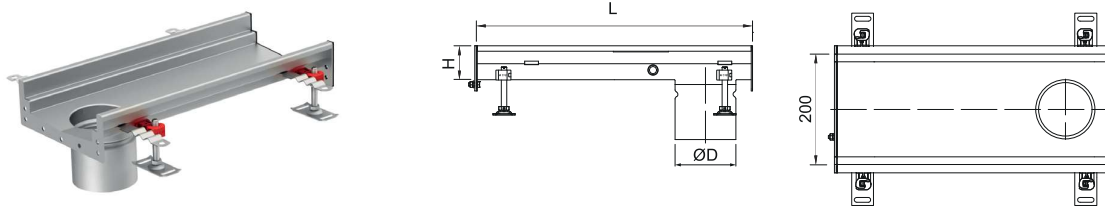

| Dimensions | | Gully | Outlet diameter øD [mm] | Item number | |
|------------|--------|------------------------|----------------------------|---------------|---------------|
| L [mm] | H [mm] | | | 1.4301 | 1.4404 |
| 500 | 60 | ACO gully EG150 | 110 | 414275 | 414283 |
| | 70 | | | 414276 | 414284 |
| | 80 | | | 414277 | 414285 |
| | 90 | | | 414278 | 414286 |
| | 100 | | | 414279 | 414287 |
| | 110 | | | 414280 | 414288 |
| | 120 | | | 414281 | 414289 |
| | 140 | | | 414282 | 414290 |
| 1000 | 60 | | | 414291 | 414299 |
| | 70 | | | 414292 | 414300 |
| | 80 | | | 414293 | 414301 |
| | 90 | | | 414294 | 414302 |
| | 100 | | | 414295 | 414303 |
| | 110 | | | 414296 | 414304 |
| | 120 | | | 414297 | 414305 |
| | 140 | | | 414298 | 414306 |
| 500 | 60 | ACO hygienic gully 157 | 142 | 409900 | 409908 |
| | 70 | | | 409901 | 409909 |
| | 80 | | | 409902 | 409910 |
| | 90 | | | 409903 | 409911 |
| | 100 | | | 409904 | 409912 |
| | 110 | | | 409905 | 409913 |
| | 120 | | | 409906 | 409914 |
| | 140 | | | 409907 | 409915 |
| 1000 | 60 | | | 409932 | 409940 |
| | 70 | | | 409933 | 409941 |
| | 80 | | | 409934 | 409942 |
| | 90 | | | 409935 | 409943 |
| | 100 | | | 409936 | 409944 |
| | 110 | | | 409937 | 409945 |
| | 120 | | | 409938 | 409946 |
| | 140 | | | 409939 | 409947 |

Note: Note: Items are equipped with seal and connecting material on one side.

End outlet

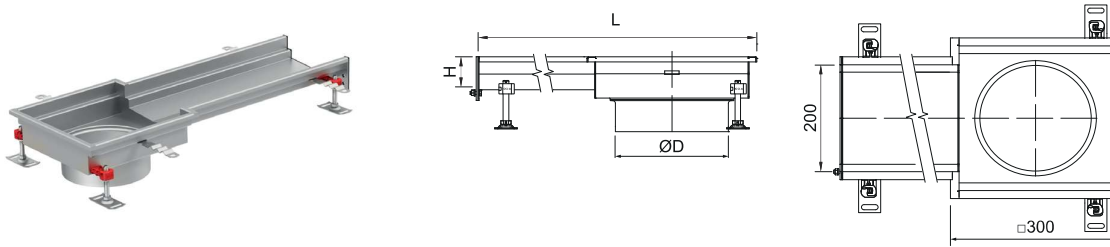

| Dimensions | | Gully | Outlet diameter ØD [mm] | Item number | |
|------------|--------|------------------------|----------------------------|---------------|---------------|
| L [mm] | H [mm] | | | 1.4301 | 1.4404 |
| 785 | 60 | ACO hygienic gully 218 | 200 | 414259 | 414267 |
| | 70 | | | 414260 | 414268 |
| | 80 | | | 414261 | 414269 |
| | 90 | | | 414262 | 414270 |
| | 100 | | | 414263 | 414271 |
| | 110 | | | 414264 | 414272 |
| | 120 | | | 414265 | 414273 |
| | 140 | | | 414266 | 414274 |

Note: Items are equipped with seal and connecting material on one side.

Centre outlet

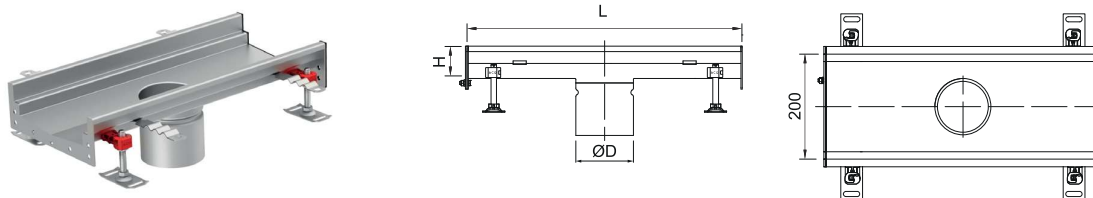

| Dimensions | | Gully | Outlet diameter øD [mm] | Item number | |
|------------|--------|------------------------|----------------------------|---------------|---------------|
| L [mm] | H [mm] | | | 1.4301 | 1.4404 |
| 500 | 60 | ACO gully EG150 | 110 | 414307 | 414315 |
| | 70 | | | 414308 | 414316 |
| | 80 | | | 414309 | 414317 |
| | 90 | | | 414310 | 414318 |
| | 100 | | | 414311 | 414319 |
| | 110 | | | 414312 | 414320 |
| | 120 | | | 414313 | 414321 |
| | 140 | | | 414314 | 414322 |
| 1000 | 60 | | | 414323 | 414331 |
| | 70 | | | 414324 | 414332 |
| | 80 | | | 414325 | 414333 |
| | 90 | | | 414326 | 414334 |
| | 100 | | | 414327 | 414335 |
| | 110 | | | 414328 | 414336 |
| | 120 | | | 414329 | 414337 |
| | 140 | | | 414330 | 414338 |
| 500 | 60 | ACO hygienic gully 157 | 142 | 409916 | 409924 |
| | 70 | | | 409917 | 409925 |
| | 80 | | | 409918 | 409926 |
| | 90 | | | 409919 | 409927 |
| | 100 | | | 409920 | 409928 |
| | 110 | | | 409921 | 409929 |
| | 120 | | | 409922 | 409930 |
| | 140 | | | 409923 | 409931 |
| 1000 | 60 | | | 409948 | 409956 |
| | 70 | | | 409949 | 409957 |
| | 80 | | | 409950 | 409958 |
| | 90 | | | 409951 | 409959 |
| | 100 | | | 409952 | 409960 |
| | 110 | | | 409953 | 409961 |
| | 120 | | | 409954 | 409962 |
| | 140 | | | 409955 | 409963 |

Note: Items are equipped with seal and connecting material on one side.

Centre outlet

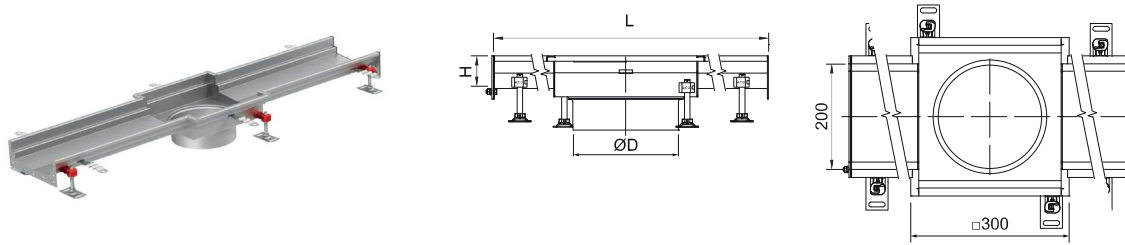

| Dimensions | | Gully | Outlet diameter ØD [mm] | Item number | |
|------------|--------|------------------------|----------------------------|---------------|---------------|
| L [mm] | H [mm] | | | 1.4301 | 1.4404 |
| 1270 | 60 | ACO hygienic gully 218 | 200 | 414243 | 414251 |
| | 70 | | | 414244 | 414252 |
| | 80 | | | 414245 | 414253 |
| | 90 | | | 414246 | 414254 |
| | 100 | | | 414247 | 414255 |
| | 110 | | | 414248 | 414256 |
| | 120 | | | 414249 | 414257 |
| | 140 | | | 414250 | 414258 |

Note: Items are equipped with seal and connecting material on one side.

End plate

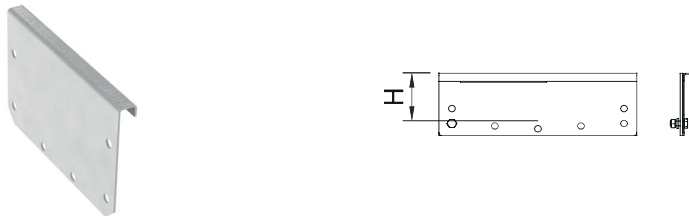

| Dimensions [mm] | Item number | |
|--------------------|---------------|---------------|
| | 1.4301 | 1.4404 |
| 55 | 402683 | 402684 |
| 60 | 402028 | 402029 |
| 70 | 402030 | 402031 |
| 80 | 402514 | 402515 |
| 90 | 402032 | 402033 |
| 100 | 402516 | 402517 |
| 110 | 402518 | 402519 |
| 120 | 402036 | 402037 |
| 140 | 402520 | 402521 |

Note: Items are equipped with seal and connecting material.

End plate with 50 mm outlet

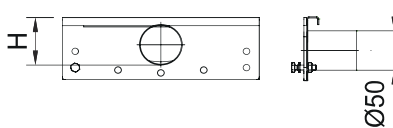

| Dimensions H [mm] | Item number | |
|----------------------|---------------|---------------|
| | 1.4301 | 1.4404 |
| 55 | 402001 | 402002 |
| 60 | 402003 | 402004 |
| 70 | 402005 | 402006 |
| 80 | 402034 | 402035 |
| 90 | 402007 | 402008 |
| 100 | 402024 | 402025 |
| 110 | 402020 | 402021 |
| 120 | 402022 | 402023 |
| 140 | 401999 | 402000 |

Note: Items are equipped with seal and connecting material.

Seal rubber

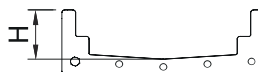
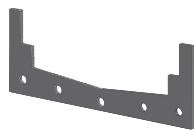

| Dimensions H [mm] | Item number |
|----------------------|---------------|
| | NBR |
| 60 | 413593 |
| 70 | 413594 |
| 80 | 413595 |
| 90 | 413596 |
| 100 | 413597 |
| 110 | 413598 |
| 120 | 413599 |
| 140 | 413600 |

Note: Items include seal and connecting material.

Gratings for ACO modular box channel 200

Product information

- Fully tested and classified to EN 1433
- Available in 1.4301 (304) or 1.4404 (316L) grades of stainless steel
- Special length 300 mm for branches and corner units
- Slip resistant gratings available for added user safety
- Load classes A 15, B 125 and C 250

ACO mesh grating

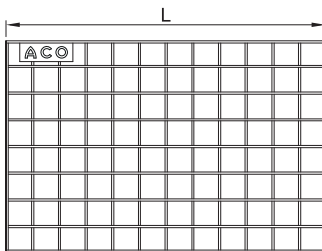

| Length L [mm] | Load class | Slip resistant | Material | Item number |
|------------------|------------|----------------|----------|---------------|
| 300 | A 15 | No | 1.4301 | 414141 |
| | | | 1.4404 | 414191 |
| | | Yes | 1.4301 | 414140 |
| | | | 1.4404 | 414190 |
| 500 | A 15 | No | 1.4301 | 92207 |
| | | | 1.4404 | 92257 |
| | | Yes | 1.4301 | 92200 |
| | | | 1.4404 | 92250 |
| 1000 | A 15 | No | 1.4301 | 92208 |
| | | | 1.4404 | 92258 |
| | | Yes | 1.4301 | 92201 |
| | | | 1.4404 | 92251 |

ACO ladder grating

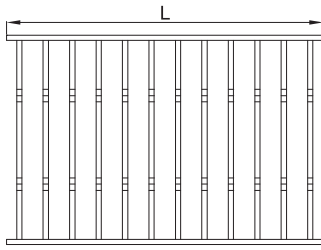

| Length L [mm] | Load class | Slip resistant | Material | Item number |
|------------------|------------|----------------|----------|---------------|
| 300 | C 250 | Yes | 1.4301 | 414142 |
| | | | 1.4404 | 414192 |
| 500 | C 250 | Yes | 1.4301 | 92214 |
| | | | 1.4404 | 92264 |
| 1000 | C 250 | Yes | 1.4301 | 92215 |
| | | | 1.4404 | 92265 |

ACO perforated grating

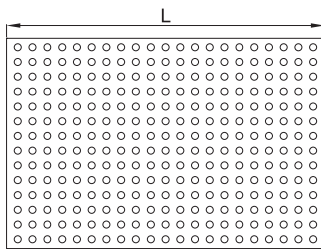

| Length L [mm] | Load class | Slip resistant | Material | Item number |
|------------------|------------|----------------|----------|---------------|
| 300 | A 15 | No | 1.4301 | 414143 |
| | | | 1.4404 | 414193 |
| 500 | A 15 | No | 1.4301 | 402689 |
| | | | 1.4404 | 405188 |
| 1000 | A 15 | No | 1.4301 | 402688 |
| | | | 1.4404 | 405187 |

ACO multi-slot 5 grating

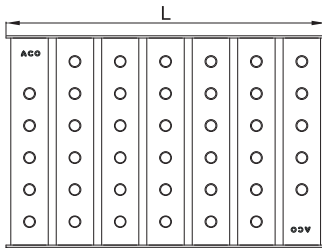

| Length L [mm] | Load class | Slip resistant | Material | Item number |
|------------------|------------|----------------|----------|---------------|
| 300 | A 15 | Yes | 1.4301 | 414145 |
| | | | 1.4404 | 414195 |
| 500 | A 15 | Yes | 1.4301 | 409292 |
| | | | 1.4404 | 409293 |
| | B 125 | Yes | 1.4301 | 409296 |
| | | | 1.4404 | 409297 |
| 1000 | A 15 | Yes | 1.4301 | 409288 |
| | | | 1.4404 | 409289 |
| | B 125 | Yes | 1.4301 | 409240 |
| | | | 1.4404 | 409241 |

ACO multi-slot 8 grating

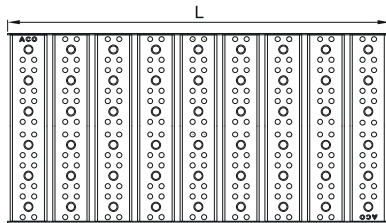

| Length L [mm] | Load class | Slip resistant | Material | Item number |
|------------------|------------|----------------|----------|---------------|
| 500 | A 15 | Yes | 1.4301 | 415741 |
| | | | 1.4404 | 415742 |
| | B 125 | Yes | 1.4301 | 415749 |
| | | | 1.4404 | 415750 |
| 1000 | A 15 | Yes | 1.4301 | 415737 |
| | | | 1.4404 | 415738 |
| | B 125 | Yes | 1.4301 | 415745 |
| | | | 1.4404 | 415746 |

Accessories for ACO modular box channel 200

ACO channel

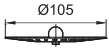
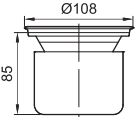
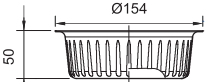
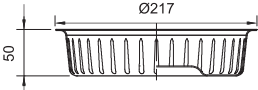
| | Description | Used with | Material | Item number |
|--|--|--|----------|---------------|
|  | Sieve ■ Stainless steel | ■ ACO modular box channel 200 with outlet 110 mm | 1.4301 | 97235 |
| | | | 1.4404 | 97285 |
|  | Foul air trap ■ Stainless steel ■ Water seal 50 mm | ■ ACO modular box channel 200 with outlet 110 mm | 1.4301 | 97217 |
| | | | 1.4404 | 97267 |
|  | Silt basket ■ Stainless steel ■ 0.6 litre capacity | ■ ACO modular box channel 200 with outlet 142 mm | 1.4301 | 408202 |
| | | | 1.4404 | 408212 |
|  | Silt basket ■ Stainless steel ■ 1,4 litre capacity | ■ ACO modular box channel 200 with outlet 200 mm | 1.4301 | 408222 |
| | | | 1.4404 | 408232 |

ACO modular slot channel 20 - standard articles

Product information

Ideal for wash-down applications or as a water break between designed wet and dry areas.

Modular concept allows specification of standard channel units to surround machinery and fit within existing tiling patterns.

Vee-bottomed (V) profiled channel for enhanced flow efficiency at low flow rates and for improved self cleaning performance.

- Fully compliant to EN 1253
- Fully tested and classified to EN 1433
- Available in 1.4301 (304) or 1.4404 (316L) grades of stainless steel, Fully pickled and passivated
- Wide range of gratings for load class up to C 250 (EN 1433)

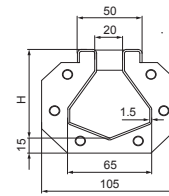

Level invert channel

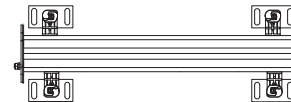
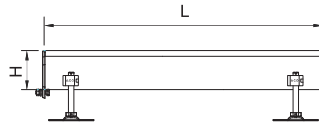

| L [mm] | Dimensions | | Item number | |
|--------|------------|--|--------------|--------------|
| | H [mm] | | 1.4301 | 1.4404 |
| 500 | 70 | | 92300 | 92350 |
| | 90 | | 92301 | 92351 |
| | 120 | | 92302 | 92352 |
| 1000 | 70 | | 92305 | 92355 |
| | 90 | | 92306 | 92356 |
| | 120 | | 92307 | 92357 |
| 2000 | 70 | | 92310 | 92360 |
| | 90 | | 92311 | 92361 |
| | 120 | | 92312 | 92362 |
| 3000 | 70 | | 92316 | 92366 |
| | 90 | | 92317 | 92367 |
| | 120 | | 92318 | 92368 |

Note: Items are equipped with seal and connecting material on one side.

Sloping invert channel

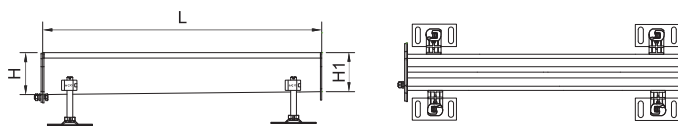

| L [mm] | Dimensions | | Item number | |
|--------|------------|---------|---------------|---------------|
| | H1 [mm] | H2 [mm] | 1.4301 | 1.4404 |
| 500 | 70 | 75 | 92303 | 92353 |
| | 75 | 80 | 92304 | 92354 |
| 1000 | 70 | 75 | 92308 | 92358 |
| | 75 | 80 | 92309 | 92359 |
| 2000 | 70 | 80 | 92313 | 92363 |
| | 80 | 90 | 92314 | 92364 |
| | 90 | 100 | 92315 | 92365 |
| 3000 | 70 | 80 | 92319 | 92369 |
| | 80 | 90 | 92320 | 92370 |
| | 90 | 100 | 92321 | 92371 |
| | 100 | 110 | 92322 | 92372 |
| 6000 | 110 | 120 | 92323 | 92373 |
| | 70 | 90 | 409014 | 409015 |
| | 90 | 110 | 409016 | 409017 |

Note: Items are equipped with seal and connecting material on deeper side only. See page 114 for more details.

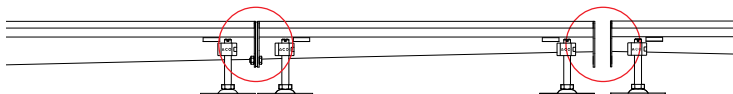

Corner unit

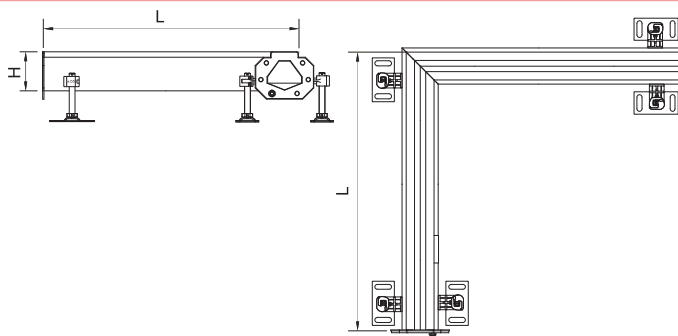

| L [mm] | Dimensions | | Item number | |
|--------|------------|--|--------------|--------------|
| | H [mm] | | 1.4301 | 1.4404 |
| 500 | 70 | | 92338 | 92388 |
| | 75 | | 92339 | 92389 |
| | 80 | | 92340 | 92390 |
| | 90 | | 92341 | 92391 |
| | 100 | | 92342 | 92392 |
| | 110 | | 92343 | 92393 |
| | 120 | | 92344 | 92394 |

Note: Items are equipped with seal and connecting material on one side.

Branch unit

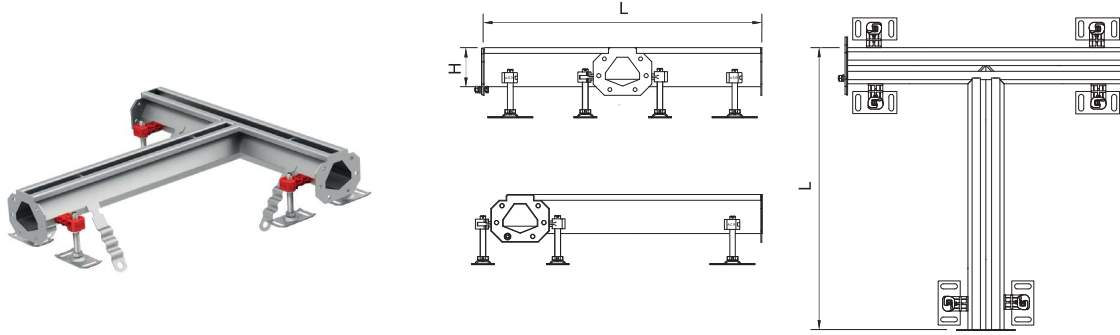

| Dimensions | | Item number | |
|------------|--------|--------------|--------------|
| L [mm] | H [mm] | 1.4301 | 1.4404 |
| 500 | 70 | 92345 | 92395 |
| | 75 | 92346 | 92396 |
| | 80 | 92347 | 92397 |
| | 90 | 92348 | 92398 |
| | 100 | 92349 | 92399 |
| | 110 | 92400 | 92450 |
| | 120 | 92401 | 92451 |

Note: Items are equipped with seal and connecting material on one side.

End outlet

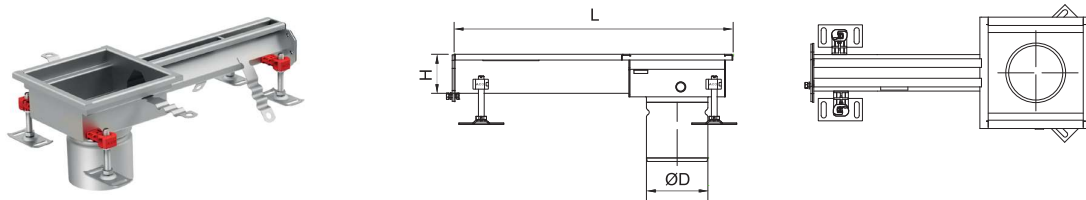

| Dimensions | | Gully | Gully top [mm] | Outlet diameter øD [mm] | Item number | |
|------------|--------|---------------------------|-------------------|----------------------------|---------------|---------------|
| L [mm] | H [mm] | | | | 1.4301 | 1.4404 |
| 500 | 70 | ACO gully EG150 | 200 x 200 | 110 | 414341 | 414348 |
| | 75 | | | | 414342 | 414349 |
| | 80 | | | | 414343 | 414350 |
| | 90 | | | | 414344 | 414351 |
| | 100 | | | | 414345 | 414352 |
| | 110 | | | | 414346 | 414353 |
| | 120 | | | | 414347 | 414354 |
| | 70 | ACO hygienic gully 142 | 200 x 200 | 125 | 415925 | 415970 |
| | 75 | | | | 415926 | 415971 |
| | 80 | | | | 415927 | 415972 |
| | 90 | | | | 415928 | 415973 |
| | 100 | | | | 415929 | 415974 |
| | 110 | | | | 415930 | 415975 |
| | 120 | | | | 415931 | 415976 |
| | 70 | ACO hygienic gully 157 | 250 x 250 | 142 | 414201 | 414208 |
| | 75 | | | | 414202 | 414209 |
| | 80 | | | | 414203 | 414210 |
| | 90 | | | | 414204 | 414211 |
| | 100 | | | | 414205 | 414212 |
| | 110 | | | | 414206 | 414213 |
| | 120 | | | | 414207 | 414214 |

Note: Items are equipped with seal and connecting material on one side.

ACO modular channel
ACO modular slot channel 20 - standard articles

Centre outlet

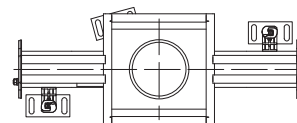
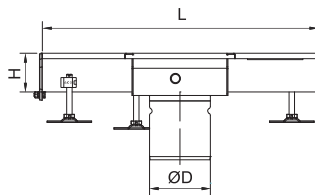

| Dimensions | | Gully | Gully top [mm] | Outlet diameter øD [mm] | Item number | |
|------------|--------|---------------------------|-------------------|----------------------------|---------------------------|---------------|
| L [mm] | H [mm] | | | | 1.4301 | 1.4404 |
| 500 | 70 | ACO gully EG150 | 200 x 200 | 110 | 414355 | 414362 |
| | 75 | | | | 414356 | 414363 |
| | 80 | | | | 414357 | 414364 |
| | 90 | | | | 414358 | 414365 |
| | 100 | | | | 414359 | 414366 |
| | 110 | | | | 414360 | 414367 |
| | 120 | | | | 414361 | 414368 |
| 1000 | 70 | | | | 414369 | 414376 |
| | 75 | | | | 414370 | 414377 |
| | 80 | | | | 414371 | 414378 |
| | 90 | | | | 414372 | 414379 |
| | 100 | | | | 414373 | 414380 |
| | 110 | | | | 414374 | 414381 |
| 500 | 120 | | | | ACO hygienic gully 142 | 200 x 200 |
| | 70 | 415932 | 415977 | | | |
| | 75 | 415933 | 415978 | | | |
| | 80 | 415934 | 415979 | | | |
| | 90 | 415935 | 415980 | | | |
| | 100 | 415936 | 415981 | | | |
| | 110 | 415937 | 415982 | | | |
| 1000 | 120 | 415938 | 415983 | | | |
| | 70 | 415939 | 415984 | | | |
| | 75 | 415940 | 415985 | | | |
| | 80 | 415941 | 415986 | | | |
| | 90 | 415942 | 415987 | | | |
| | 100 | 415943 | 415988 | | | |
| 500 | 110 | ACO hygienic gully 157 | 250 x 250 | 142 | | |
| | 120 | | | | 415945 | 415990 |
| | 70 | | | | 414215 | 414222 |
| | 75 | | | | 414216 | 414223 |
| | 80 | | | | 414217 | 414224 |
| | 90 | | | | 414218 | 414225 |
| | 100 | | | | 414219 | 414226 |
| 1000 | 110 | | | | 414220 | 414227 |
| | 120 | | | | 414221 | 414228 |
| | 70 | | | | 414229 | 414236 |
| | 75 | | | | 414230 | 414237 |
| | 80 | | | | 414231 | 414238 |
| | 90 | | | | 414232 | 414239 |
| 1000 | 100 | | | | 414233 | 414240 |
| | 110 | 414234 | 414241 | | | |
| | 120 | 414235 | 414242 | | | |

Note: Items are equipped with seal and connecting material on one side.

End plate

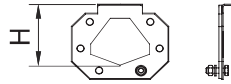

| Dimensions H [mm] | Item number | |
|----------------------|--------------|--------------|
| | | 1.4301 |
| 70 | 92324 | 92374 |
| 75 | 92325 | 92375 |
| 80 | 92326 | 92376 |
| 90 | 92327 | 92377 |
| 100 | 92328 | 92378 |
| 110 | 92329 | 92379 |
| 120 | 92330 | 92380 |

Note: Items are equipped with seal and connecting material.

End plate with 50 mm outlet

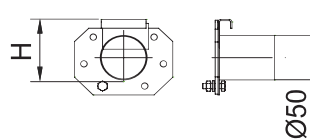

| Dimensions H [mm] | Item number | |
|----------------------|--------------|--------------|
| | | 1.4301 |
| 70 | 92331 | 92381 |
| 75 | 92332 | 92382 |
| 80 | 92333 | 92383 |
| 90 | 92334 | 92384 |
| 100 | 92335 | 92385 |
| 110 | 92336 | 92386 |
| 120 | 92337 | 92387 |

Note: Items are equipped with seal and connecting material.

Seal rubber

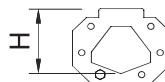

| Dimensions H [mm] | Item number |
|----------------------|---------------|
| | NBR |
| 70 | 413601 |
| 75 | 413602 |
| 80 | 413603 |
| 90 | 413604 |
| 100 | 413605 |
| 110 | 413606 |
| 120 | 413607 |

Note: Items include seal and connecting material.

Accessories for ACO modular slot channel 20

ACO channel

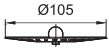
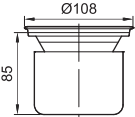
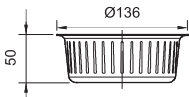
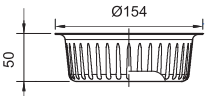
| | Description | Used with | Material | Item number |
|--|--|--|----------|---------------|
|  | Sieve ■ Stainless steel | ■ ACO modular slot channel 20 with outlet 110 mm | 1.4301 | 97235 |
| | | | 1.4404 | 97285 |
|  | Foul air trap ■ Stainless steel ■ Water seal 50 mm | ■ ACO modular slot channel 20 with outlet 110 mm | 1.4301 | 97217 |
| | | | 1.4404 | 97267 |
|  | Silt basket ■ Stainless steel ■ 0.5 litre capacity | ■ ACO modular slot channel 20 with outlet 125 mm | 1.4301 | 414339 |
| | | | 1.4404 | 414340 |
|  | Silt basket ■ Stainless steel ■ 0.6 litre capacity | ■ ACO modular slot channel 20 with outlet 142 mm | 1.4301 | 408202 |
| | | | 1.4404 | 408212 |

ACO modular channel - semi-standard

Product information

Semi-standard items offer/provide easy and fast way to get a slot or box channel of a special length to complete a linear drainage project with standard stock items. Simply specify the length you need.

How to specify semi-standard items:
Specify the part number from which the semi-standard item will be produced.

How it works:

The semi-standard item is produced from a standard stock item (level invert and sloping invert channels only) which is shortened according to customer's need. The shortened item is then equipped with flange and sealing; to fit the following channel in the drainage project. Grating of the same length is also produced.

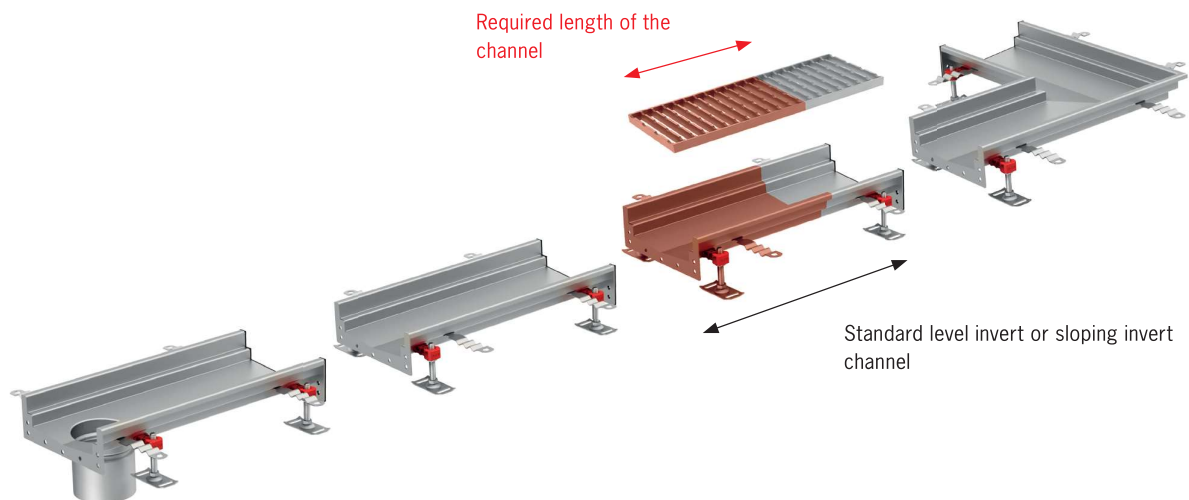

- Specify the required length of the item (length always starts at lower height of channel if channel with invert slope used).

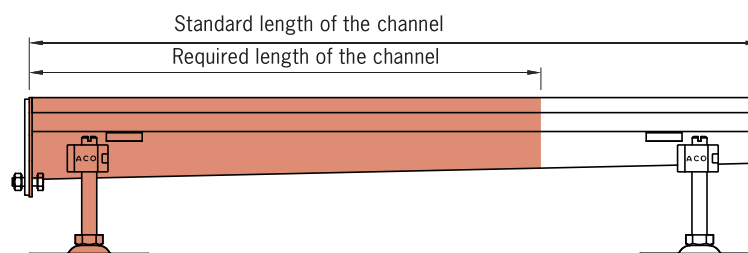

ACO design channel

Product information

Even atypical solutions can be easily realised using stainless steel. The broad spectrum of finishes and shapes gives complete design freedom.

Customers' individual channel designs will be managed by our expert team with tailor-made services for specific projects with full proposal information, CAD layout drawings and assembly instructions. Contact our Sales/Technical department team and we will help you with your project.

ACO channel

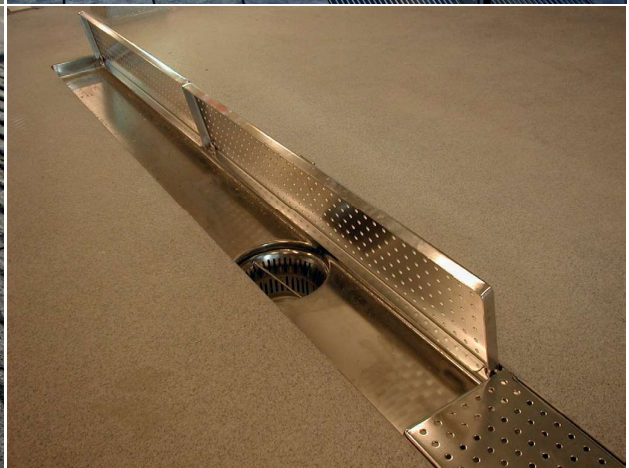
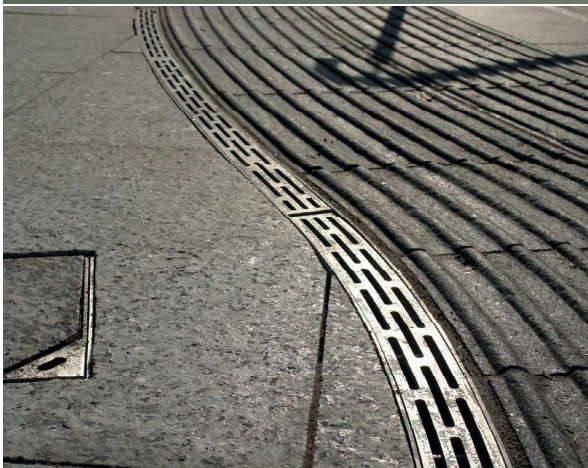

Flow rates and Construction heights

ACO channel, ACO hygienic gully 142

| Outlet diameter | Outlet position | Flow rate [l/s] | |
|-----------------|-----------------|-----------------|--------------|
| øD | | H = 60 mm | |
| | | A min. = 85 | A max. = 115 |
| | | B min. = 194 | B max. = 224 |
| 75 | Vertical | 1.4 | 1.7 |
| 110 | | 1.6 | 1.9 |

| Outlet diameter | Outlet position | Flow rate [l/s] | |
|-----------------|-----------------|-----------------|--------------|
| øD | | H = 60 mm | |
| | | A min. = 75 | A max. = 115 |
| | | B min. = 185 | B max. = 245 |
| 75 | Horizontal | 1.4 | 1.7 |
| 110 | | 1.6 | 1.9 |

Notes:

A min. and B min. values can be reduced by 15 mm if earth screw is removed and channel outlet spigot shortened. Please be aware that channel outlet pipe shortening affects the A max. and B max. values.

Flow rates measured according to EN 1253. Flow rate performance without silt basket (flow rates with empty silt basket are approximately 15% lower than the values stated)

ACO channel, ACO hygienic gully 157

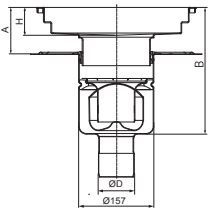
| | |  | |
|-----------------|-----------------|---|--------------|
| Outlet diameter | Outlet position | Flow rate [l/s] | |
| øD | | H = 60 mm | |
| | | A min. = 85 | A max. = 115 |
| | | B min. = 232 | B max. = 262 |
| 75 | Vertical | 2.9 | 3.1 |
| 110 | | 3.9 | 4.2 |

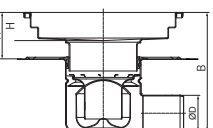
| | |  | |
|-----------------|-----------------|---|--------------|
| Outlet diameter | Outlet position | Flow rate [l/s] | |
| øD | | H = 60 mm | |
| | | A min. = 75 | A max. = 115 |
| | | B min. = 242 | B max. = 285 |
| 75 | Horizontal | 2.8 | 3.1 |
| 110 | | 3.2 | 3.9 |

Notes:

A min. and B min. values can be reduced by 15 mm if earth screw is removed and channel outlet spigot shortened. Please be aware that channel outlet pipe shortening affects the A max. and B max. values.

Flow rates measured according to EN 1253. Flow rate performance without silt basket (flow rates with empty silt basket are approximately 15% lower than the values stated)

ACO channel, ACO hygienic gully 218

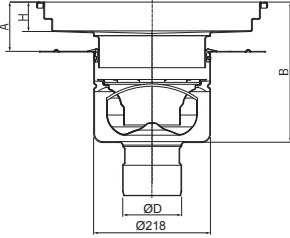
| | |  | | | | | | | | | |
|-----------------|-----------------|--|-------------------------|-------------------------|-------------------------|-------------------------|-------------------------|-------------------------|-------------------------|-------------------------|-------------------------|
| Outlet diameter | Outlet position | Flow rate [l/s] | | | | | | | | | |
| øD | | H = 60 mm | | H = 80 mm | | H = 100 mm | | H = 150 mm | | H = 200 mm | |
| | | A min. = 75 [mm] | A max. = 115 [mm] | A min. = 95 [mm] | A max. = 135 [mm] | A min. = 115 [mm] | A max. = 155 [mm] | A min. = 165 [mm] | A max. = 205 [mm] | A min. = 215 [mm] | A max. = 255 [mm] |
| | | B min. = 245 [mm] | B max. = 285 [mm] | B min. = 265 [mm] | B max. = 305 [mm] | B min. = 285 [mm] | B max. = 325 [mm] | B min. = 335 [mm] | B max. = 375 [mm] | B min. = 385 [mm] | B max. = 425 [mm] |
| 110 | Vertical | 5.4 | 5.6 | 5.6 | 5.8 | 5.7 | 6.0 | 5.9 | 6.4 | 6.4 | 6.4 |
| 160 | | 5.4 | 5.6 | 5.6 | 5.8 | 5.7 | 6.0 | 5.9 | 6.4 | 6.4 | 6.4 |

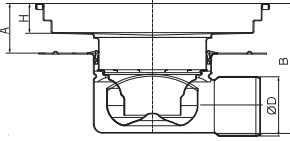
| | |  | | | | | | | | | |
|-----------------|-----------------|--|-------------------------|-------------------------|-------------------------|-------------------------|-------------------------|-------------------------|-------------------------|-------------------------|-------------------------|
| Outlet diameter | Outlet position | Flow rate [l/s] | | | | | | | | | |
| øD | | H = 60 mm | | H = 80 mm | | H = 100 mm | | H = 150 mm | | H = 200 mm | |
| | | A min. = 85 [mm] | A max. = 115 [mm] | A min. = 105 [mm] | A max. = 135 [mm] | A min. = 125 [mm] | A max. = 155 [mm] | A min. = 175 [mm] | A max. = 205 [mm] | A min. = 225 [mm] | A max. = 255 [mm] |
| | | B min. = 235 [mm] | B max. = 265 [mm] | B min. = 255 [mm] | B max. = 285 [mm] | B min. = 275 [mm] | B max. = 305 [mm] | B min. = 325 [mm] | B max. = 355 [mm] | B min. = 375 [mm] | B max. = 405 [mm] |
| 110 | Horizontal | 4.5 | 4.7 | 4.8 | 4.9 | 4.9 | 5.1 | 5.0 | 5.6 | 5.6 | 6.4 |

Notes:

A min. and B min. values can be reduced by 15 mm if earth screw is removed and channel outlet spigot shortened. Please be aware that channel outlet pipe shortening affects the A max. and B max. values.

Flow rates measured according to EN 1253. Flow rate performance without silt basket (flow rates with empty silt basket are approximately 15% lower than the values stated)

ACO channel, ACO gully EG150

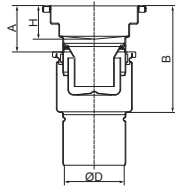
| | |  | |
|-----------------|-----------------|---|--------------|
| Outlet diameter | Outlet position | Flow rate [l/s] | |
| ØD | | H = 60 mm | |
| | | A min. = 60 | A max. = 85 |
| | | B min. = 165 | B max. = 190 |
| 75 | Vertical | 1.3 | 1.5 |
| 110 | | 1.3 | 1.5 |

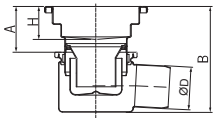
| | |  | |
|-----------------|-----------------|---|--------------|
| Outlet diameter | Outlet position | Flow rate [l/s] | |
| ØD | | H = 60 mm | |
| | | A min. = 60 | A max. = 85 |
| | | B min. = 165 | B max. = 190 |
| 75 | Horizontal | 1.3 | 1.5 |

Notes:

A min. and B min. values can be reduced by 15 mm if earth screw is removed and channel outlet spigot shortened. Please be aware that channel outlet pipe shortening affects the A max. and B max. values.

Flow rates measured according to EN 1253. Flow rate performance without silt basket (flow rates with empty silt basket are approximately 15% lower than the values stated)

Notes

